

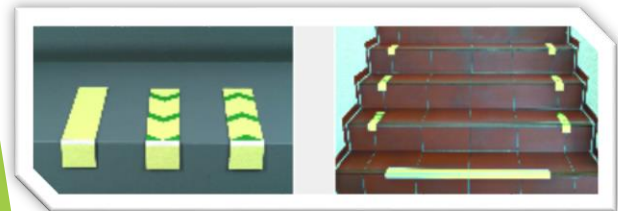

Photoluminescent System

ระบบนำทางเรืองแสงเพื่อความปลอดภัยในการอพยพ

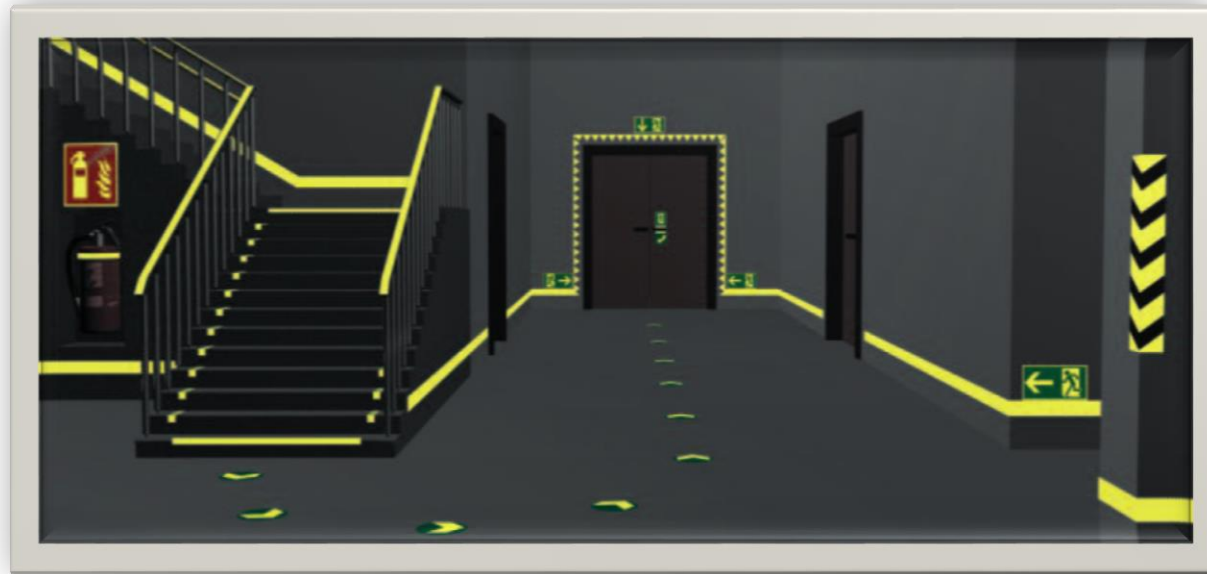
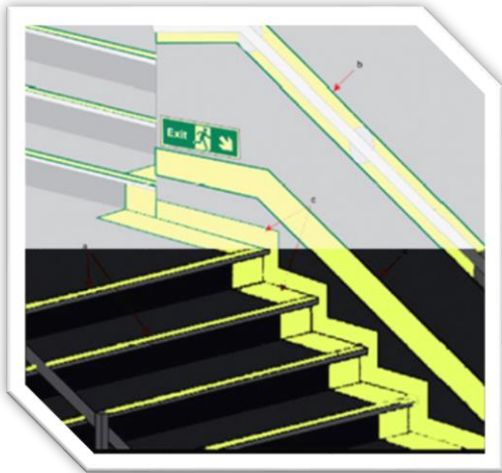

Escape Route and Fire protection signs

Safety Guidance Systems.

Warning Markings

SAFETY GUIDANCE SYSTEMS

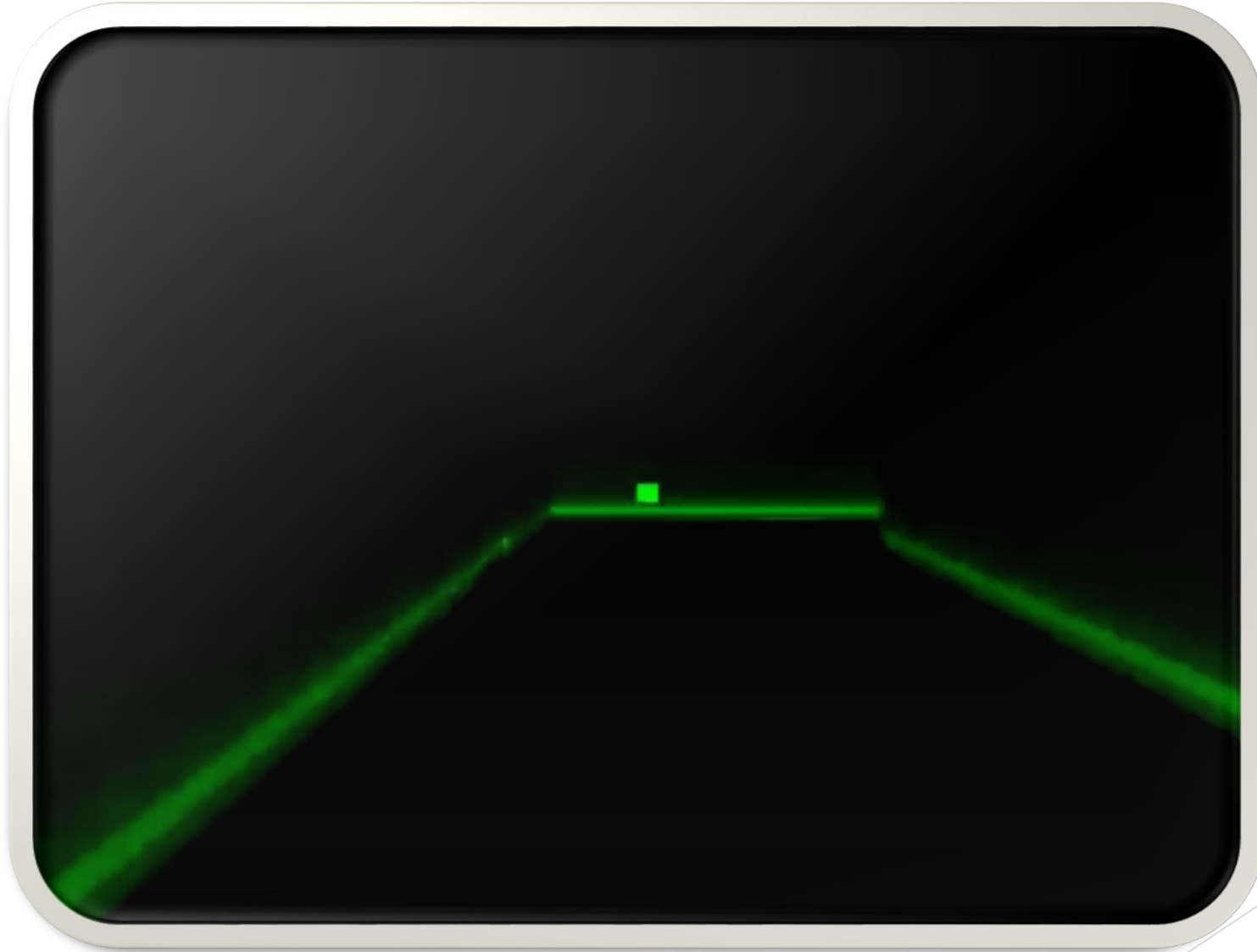

GLOW IN DARK ? PIGMENTS

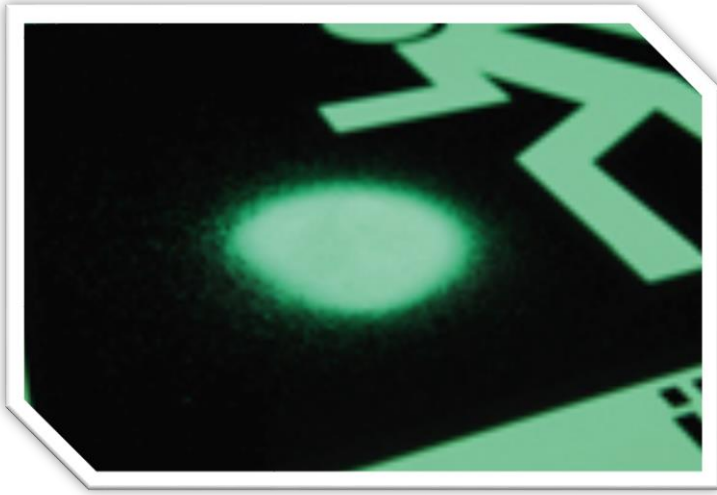

There are two sorts of photoluminescent pigments: Zinc Sulfide and alkaline earth, also called rare earth pigments. The alkaline earth pigments are higher quality pigments and reach considerably better luminance values. Depending on the application purpose, different grain sizes are being used.

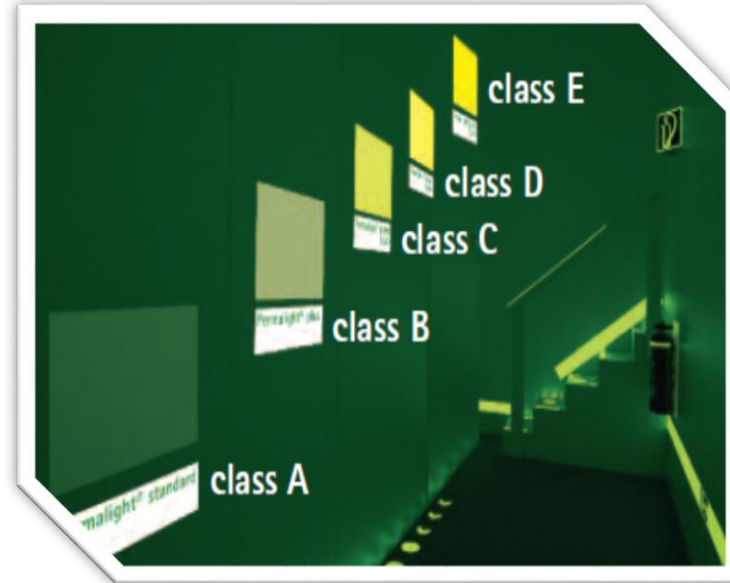



- **Non-toxic**
- **Flame retardant**
- **Work without electricity**
- **Free of Phosphorus**

STANDARD AND COMPLIANCE

- ▶ **ASTM E2072 : Standard Specification for Photoluminescent Safety Markings**
- ▶ **DIN67510 : LONGTIME AFTERGLOWING PIGMENTS AND PRODUCTS**
(Measurement and marking at the manufacturer)
- ▶ NFPA101 : Life Safety Code
- ▶ UL1994 : Luminous Egress Path Marking System
- ▶ ISO (International Organization for Standardization) : ISO 15370—Low-Location on Passenger Ships, ISO 16069—Graphical Symbols, Safety Signs, Safety Way GuLighting idance Systems (SWGS) and ISO 7010—Graphical symbols - Safety colours and safety signs -- Safety signs used in workplaces and public areas.
- ▶ etc



CAUSE CRITICAL

(ปัจจัยความเสี่ยง)

- ▶ **Earthquake** ----- แผ่นดินไหว
 - ▶ **Conflagration** ----- อัคคีภัย
 - ▶ **Terrorism** ----- วินาศกรรม
 - ▶ **Tsunami** ----- สึนามิ
- ▶ **Power failure for long time** ----- ไฟฟ้าดับเป็นเวลานาน



CAUSE CRITICAL

(ปัจจัยความเสี่ยง)

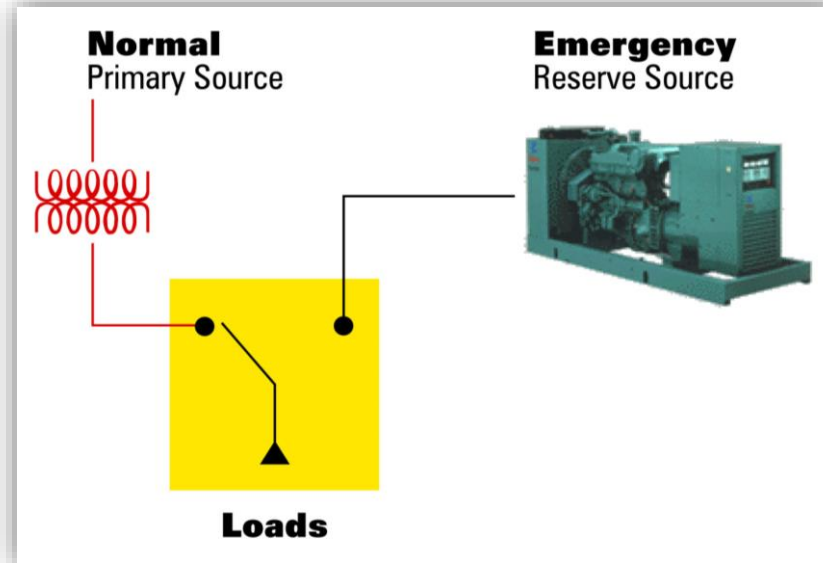
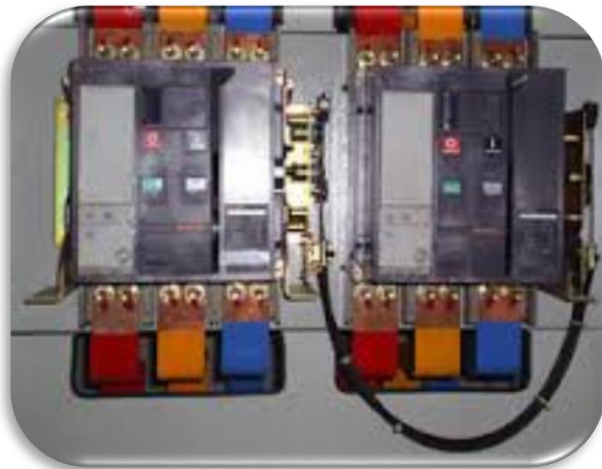

► **ATS ไม่ Transfer**

► สัญญาณสั่ง **Start** มีปัญหา

► เครื่องยนต์ขัดข้อง

ข้อกำหนดตามกฎหมาย

- ▶ จำเป็นต้องติดตั้ง ไฟฉุกเฉิน และ ป้ายบอกทาง โดยมี **Battery back up** อย่างน้อย 2 ชั่วโมง
- ▶ ความเสี่ยง
 - ไม่ทำงาน ตกหล่น จากแรงสั่นสะเทือน
 - ขาดการบำรุงรักษา แบตเตอรี่หมดอายุ
 - อาจเกิดลัดวงจร จากน้ำจากระบบดับเพลิง



ความเสี่ยง



ป้ายระบุตำแหน่งถังดับเพลิง ปกติ

- ไม่สามารถมองเห็นได้ในกรณี มีดสนิท



ความเสี่ยง



- หกล้ม บาดเจ็บ เหยียบกัน

PHOTOLUMINESCENT GUIDANCE SYSTEM

ระบบนำทางเรืองแสง
เพื่อการอพยพความปลอดภัย
Guidance System

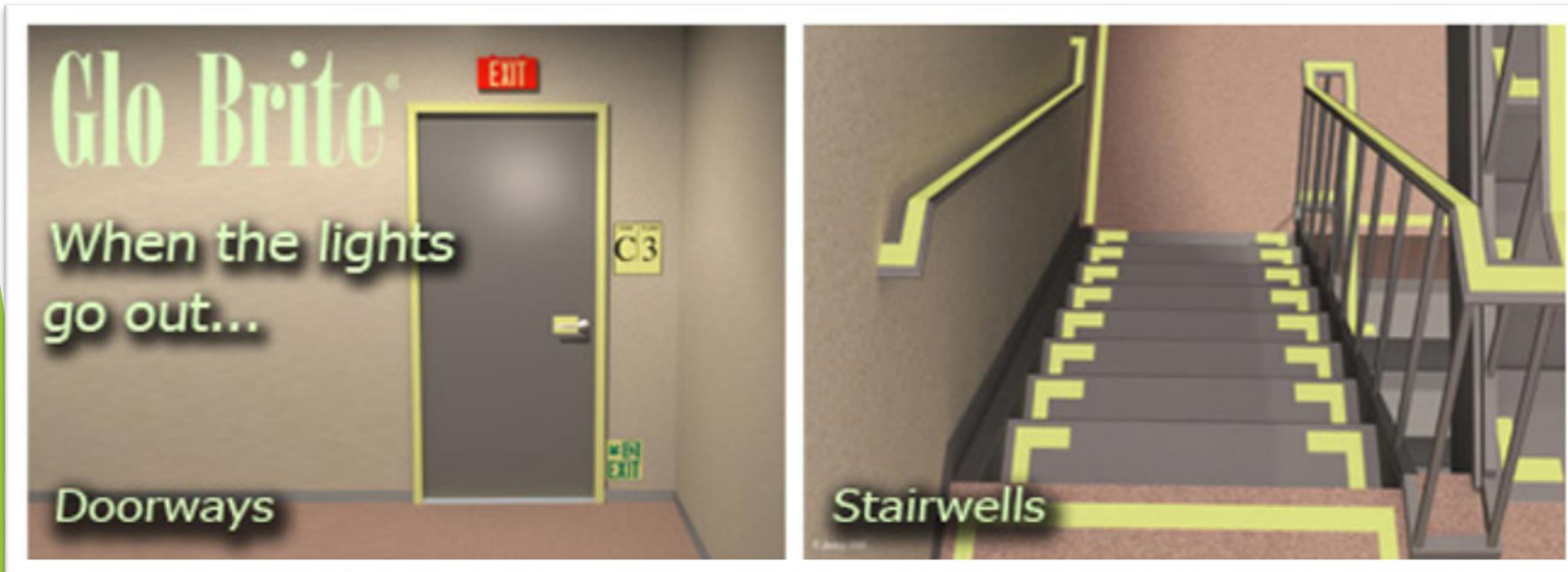

SAFETY GUIDANCE SYSTEM



1. Anti-slip marking strips for floor demarcation and showing exit path
2. Anti-slip floor dots for exit path marking
3. High level and low level directional signs
4. Bumper guards for visual warning and injury protection against obstacles
5. Marking strips highlight key switches/ID on panel cabinet
6. Photoluminous evacuation map
7. V-shape fire equipment signage

8. Fire extinguisher Backing
9. Anti-slip & warning aluminium stair nosing
10. Day Light Fluorescent anti-slip marking (R13)
11. Push Sign for door opening marking
12. Vinyl guidance line for door frame/highlight marking
13. Photoluminous Warning Marking (Blk/White)
14. Protection Corner



PERMALIGHT

Photo Reports for HV Room G07

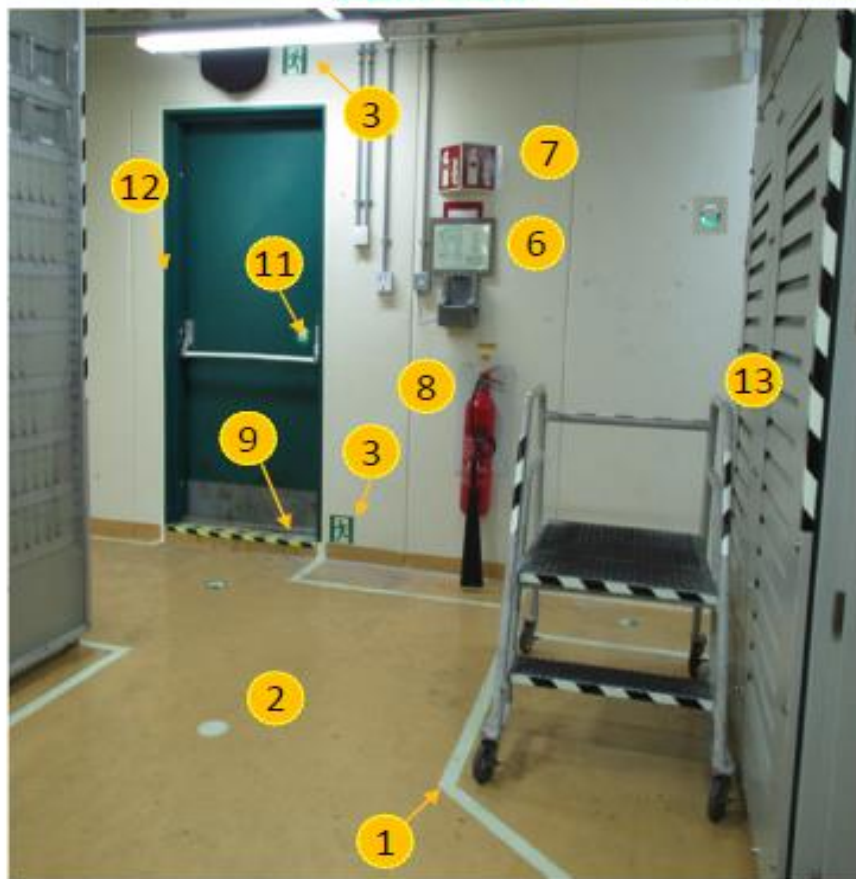

• With normal lighting

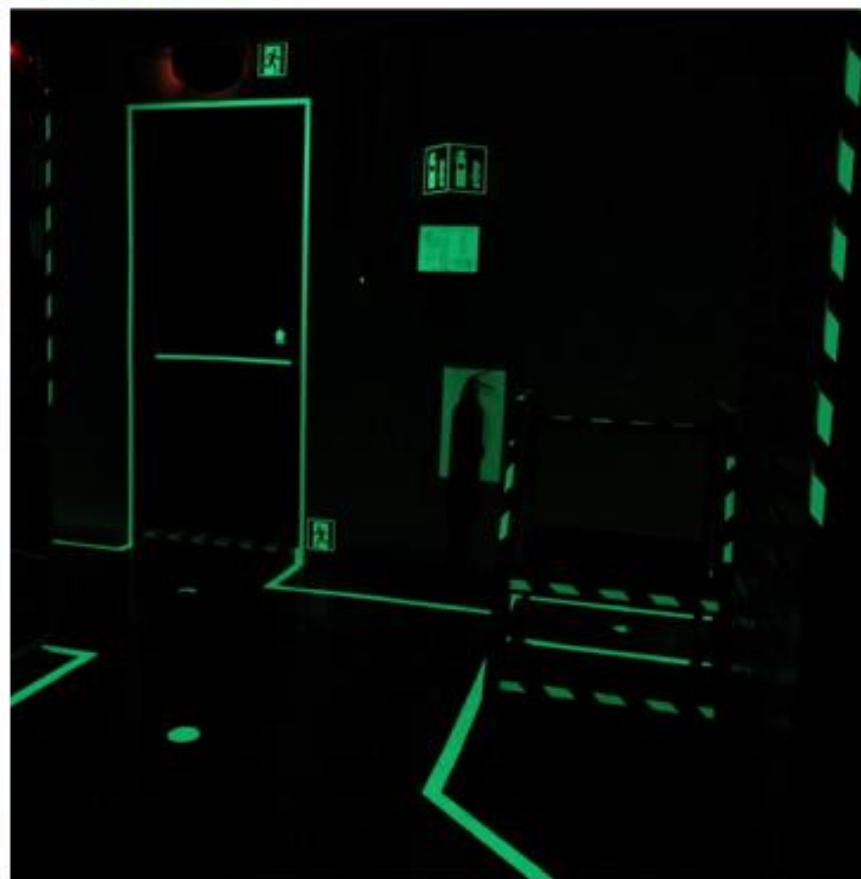

• Blackout Situation
-without normal lighting and EXIT light-box

1. Anti-slip marking strips for floor demarcation and showing exit path
2. Anti-slip floor dots for exit path marking
3. High level and low level directional signs
4. Bumper guards for visual warning and injury protection against obstacles
5. Marking strips highlight key switches/ID on panel cabinet
6. Photoluminous evacuation map
7. V-shape fire equipment signage

8. Fire extinguisher Backing
9. Anti-slip & warning aluminium stair nosing
10. Day Light Fluorescent anti-slip marking (R13)
11. Push Sign for door opening marking
12. Vinyl guidance line for door frame/highlight marking
13. Photoluminous Warning Marking (Blk/White)
14. Protection Corner



PERMALIGHT ■ Photo Reports for HV Room G07



• With normal lighting



• Blackout Situation
-without normal lighting and EXIT light-box

1. Anti-slip marking strips for floor demarcation and showing exit path
2. Anti-slip floor dots for exit path marking
3. High level and low level directional signs
4. Bumper guards for visual warning and injury protection against obstacles
5. Marking strips highlight key switches/ID on panel cabinet
6. Photoluminous evacuation map
7. V-shape fire equipment signage

8. Fire extinguisher Backing
9. Anti-slip & warning aluminium stair nosing
10. Day Light Fluorescent anti-slip marking (R13)
11. Push Sign for door opening marking
12. Vinyl guidance line for door frame/highlight marking
13. Photoluminous Warning Marking (Blk/White)
14. Protection Corner



PERMALIGHT ■ Photo Reports for HV Room G07



• With normal lighting



• Blackout Situation
-without normal lighting and EXIT light-box

1. Anti-slip marking strips for floor demarcation and showing exit path
2. Anti-slip floor dots for exit path marking
3. High level and low level directional signs
4. Bumper guards for visual warning and injury protection against obstacles
5. Marking strips highlight key switches/ID on panel cabinet
6. Photoluminous evacuation map
7. V-shape fire equipment signage

8. Fire extinguisher Backing
9. Anti-slip & warning aluminium stair nosing
10. Day Light Fluorescent anti-slip marking (R13)
11. Push Sign for door opening marking
12. Vinyl guidance line for door frame/highlight marking
13. Photoluminous Warning Marking (Blk/White)
14. Protection Corner



PERMALIGHT

Photo Reports for HV Room G07

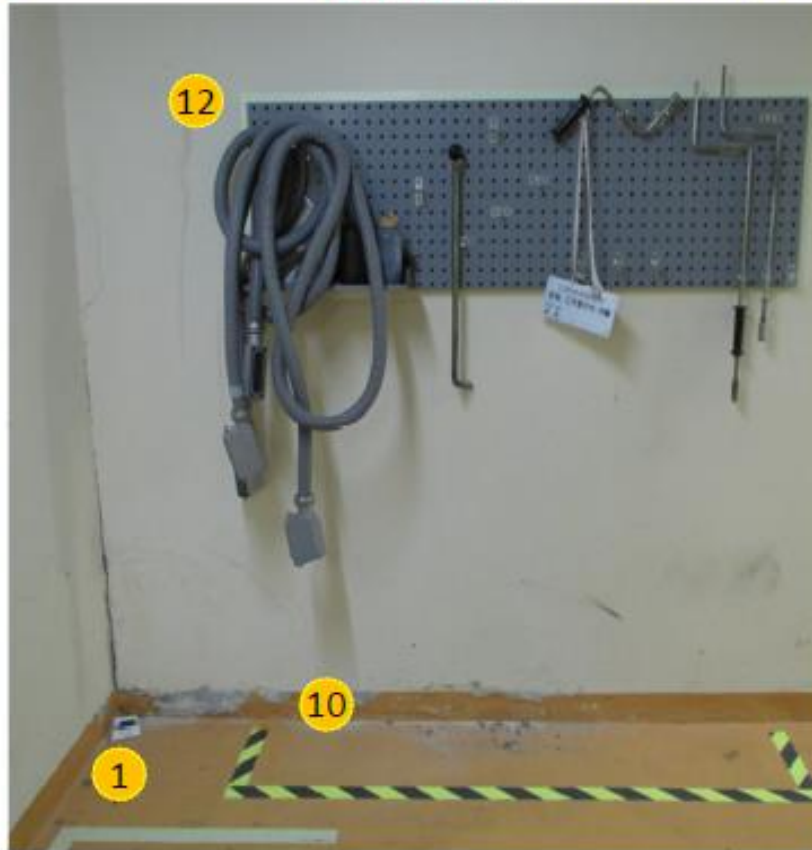

- With normal lighting

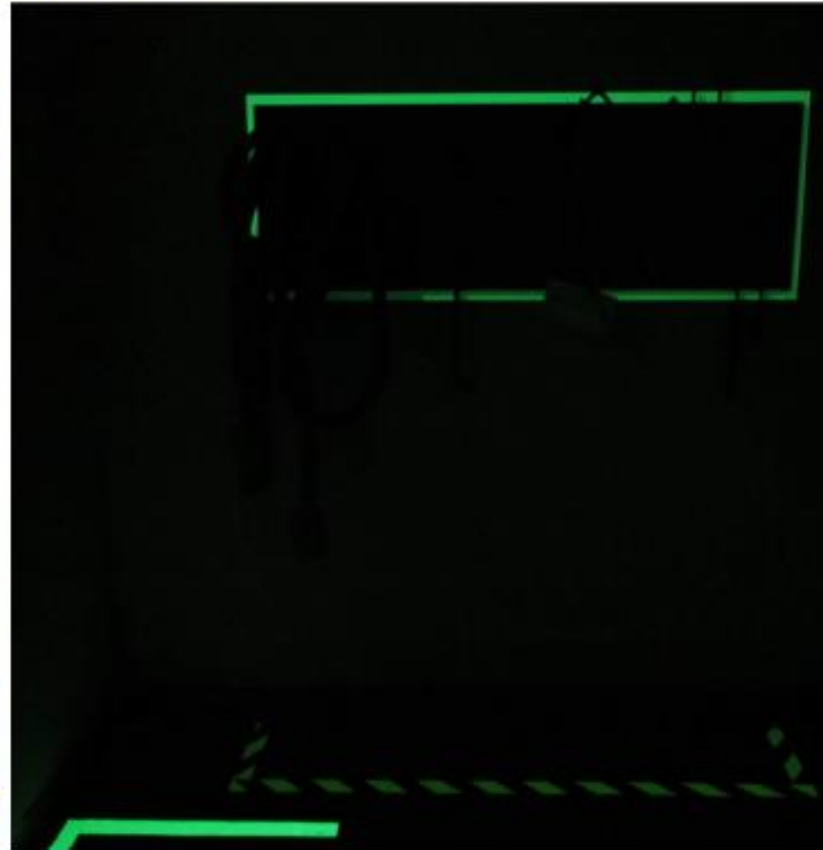

- Blackout Situation
-without normal lighting and EXIT light-box

1. Anti-slip marking strips for floor demarcation and showing exit path
2. Anti-slip floor dots for exit path marking
3. High level and low level directional signs
4. Bumper guards for visual warning and injury protection against obstacles
5. Marking strips highlight key switches/ID on panel cabinet
6. Photoluminescent evacuation map
7. V-shape fire equipment signage

8. Fire extinguisher Backing
9. Anti-slip & warning aluminium stair nosing
10. Day Light Fluorescent anti-slip marking (R13)
11. Push Sign for door opening marking
12. Vinyl guidance line for door frame/highlight marking
13. Photoluminescent Warning Marking (Blk/White)
14. Protection Corner



PERMALIGHT ■ Photo Reports for HV Room G07

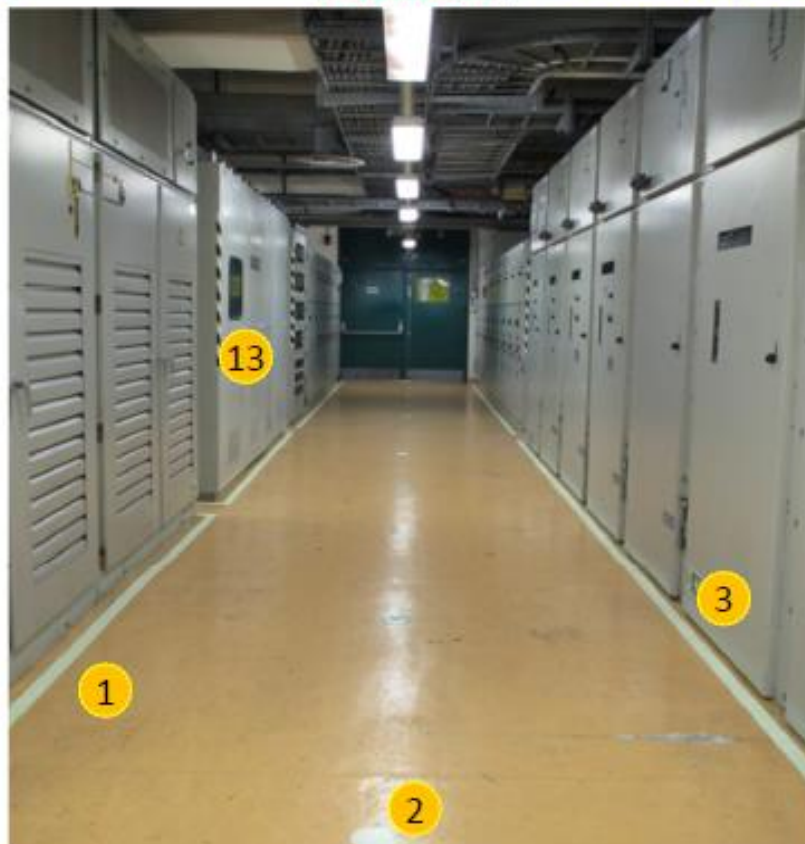

- With normal lighting

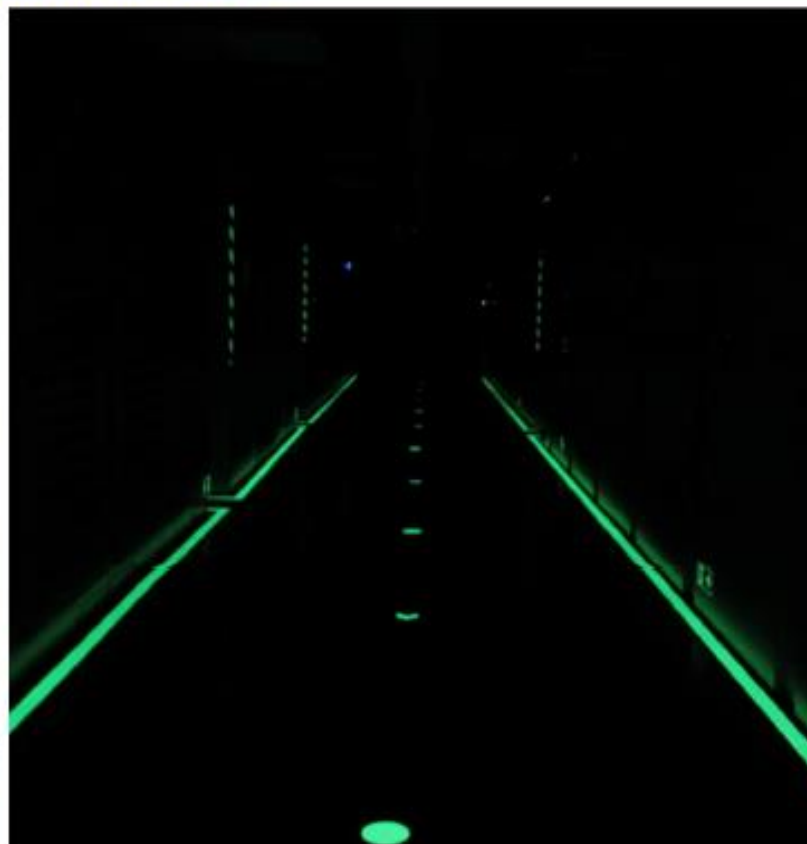

- Blackout Situation
-without normal lighting and EXIT light-box

1. Anti-slip marking strips for floor demarcation and showing exit path
2. Anti-slip floor dots for exit path marking
3. High level and low level directional signs
4. Bumper guards for visual warning and injury protection against obstacles
5. Marking strips highlight key switches/ID on panel cabinet
6. Photoluminous evacuation map
7. V-shape fire equipment signage

8. Fire extinguisher Backing
9. Anti-slip & warning aluminium stair nosing
10. Day Light Fluorescent anti-slip marking (R13)
11. Push Sign for door opening marking
12. Vinyl guidance line for door frame/highlight marking
13. Photoluminous Warning Marking (Blk/White)
14. Protection Corner



PERMALIGHT

Photo Reports for HV Room G07



• With normal lighting

• Blackout Situation
-without normal lighting and EXIT light-box

1. Anti-slip marking strips for floor demarcation and showing exit path
2. Anti-slip floor dots for exit path marking
3. High level and low level directional signs
4. Bumper guards for visual warning and injury protection against obstacles
5. Marking strips highlight key switches/ID on panel cabinet
6. Photoluminescent evacuation map
7. V-shape fire equipment signage

8. Fire extinguisher Backing
9. Anti-slip & warning aluminium stair nosing
10. Day Light Fluorescent anti-slip marking (R13)
11. Push Sign for door opening marking
12. Vinyl guidance line for door frame/highlight marking
13. Photoluminescent Warning Marking (Blk/White)
14. Protection Corner



PERMALIGHT ■ Photo Reports for HV Room G07



• With normal lighting

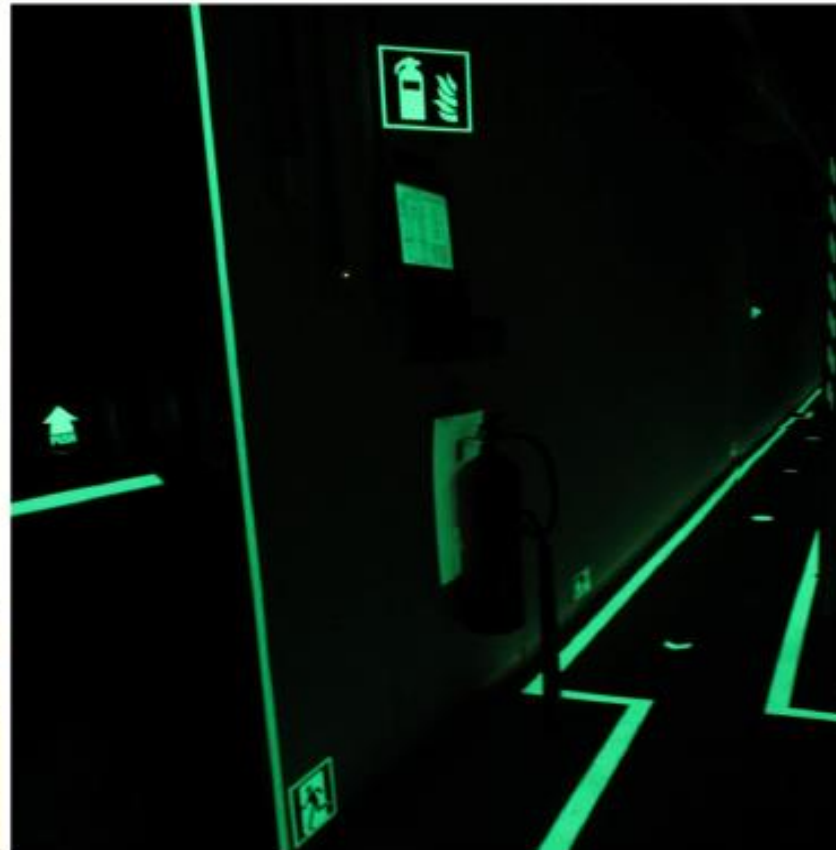

• Blackout Situation
-without normal lighting and EXIT light-box

1. Anti-slip marking strips for floor demarcation and showing exit path
2. Anti-slip floor dots for exit path marking
3. High level and low level directional signs
4. Bumper guards for visual warning and injury protection against obstacles
5. Marking strips highlight key switches/ID on panel cabinet
6. Photoluminous evacuation map
7. V-shape fire equipment signage

8. Fire extinguisher Backing
9. Anti-slip & warning aluminium stair nosing
10. Day Light Fluorescent anti-slip marking (R13)
11. Push Sign for door opening marking
12. Vinyl guidance line for door frame/highlight marking
13. Photoluminous Warning Marking (Blk/White)
14. Protection Corner



PERMALIGHT ■ Photo Reports for HV Room G07

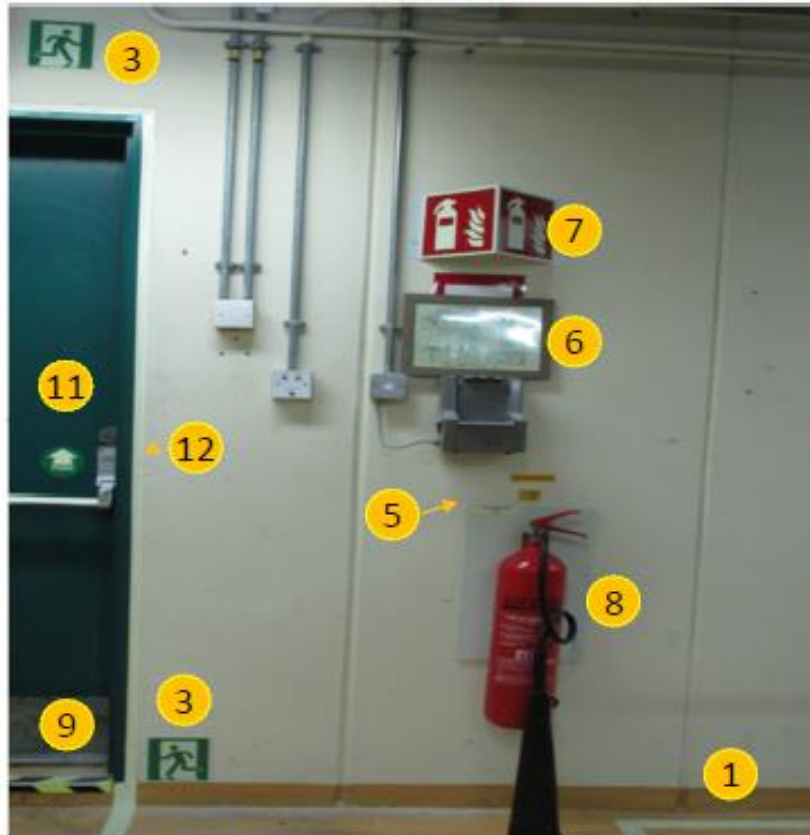

• With normal lighting



• Blackout Situation
-without normal lighting and EXIT light-box

1. Anti-slip marking strips for floor demarcation and showing exit path
2. Anti-slip floor dots for exit path marking
3. High level and low level directional signs
4. Bumper guards for visual warning and injury protection against obstacles
5. Marking strips highlight key switches/ID on panel cabinet
6. Photoluminous evacuation map
7. V-shape fire equipment signage

8. Fire extinguisher Backing
9. Anti-slip & warning aluminium stair nosing
10. Day Light Fluorescent anti-slip marking (R13)
11. Push Sign for door opening marking
12. Vinyl guidance line for door frame/highlight marking
13. Photoluminous Warning Marking (Blk/White)
14. Protection Corner



PERMALIGHT ■ Photo Reports for HV Room G07



- With normal lighting

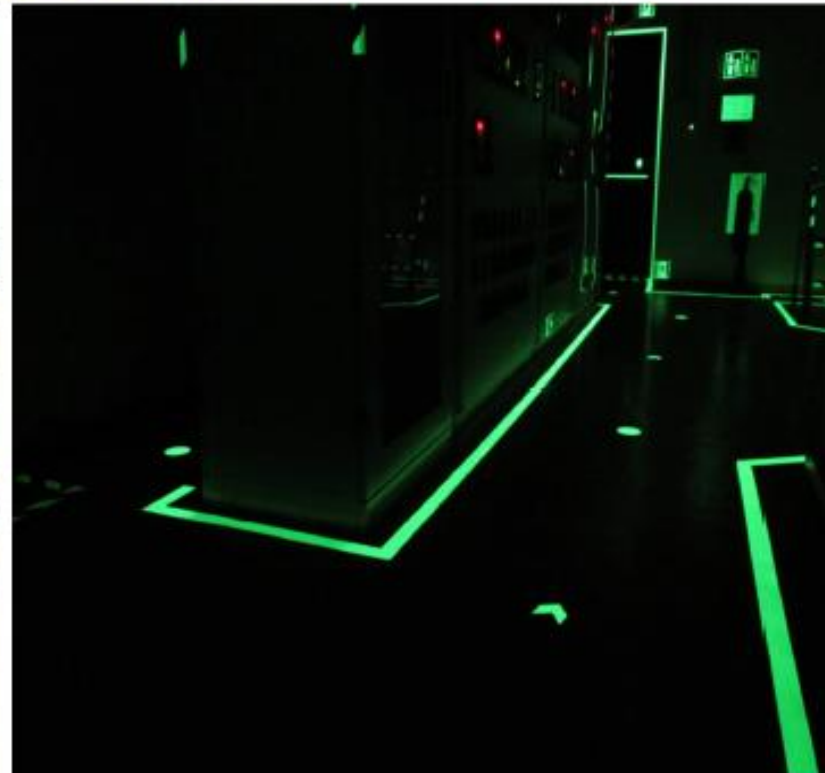

- Blackout Situation
-without normal lighting and EXIT light-box

1. Anti-slip marking strips for floor demarcation and showing exit path
2. Anti-slip floor dots for exit path marking
3. High level and low level directional signs
4. Bumper guards for visual warning and injury protection against obstacles
5. Marking strips highlight key switches/ID on panel cabinet
6. Photoluminous evacuation map
7. V-shape fire equipment signage

8. Fire extinguisher Backing
9. Anti-slip & warning aluminium stair nosing
10. Day Light Fluorescent anti-slip marking (R13)
11. Push Sign for door opening marking
12. Vinyl guidance line for door frame/highlight marking
13. Photoluminous Warning Marking (Blk/White)
14. Protection Corner



PERMALIGHT ■ Photo Reports for HV Room G07



• With normal lighting

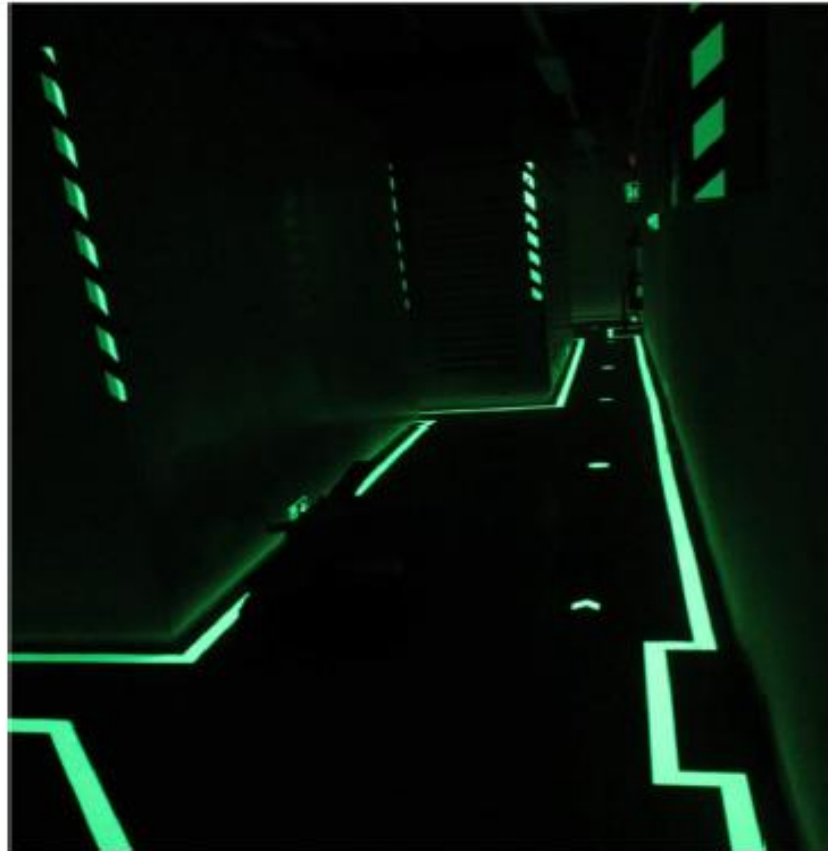

• Blackout Situation
-without normal lighting and EXIT light-box

1. Anti-slip marking strips for floor demarcation and showing exit path
2. Anti-slip floor dots for exit path marking
3. High level and low level directional signs
4. Bumper guards for visual warning and injury protection against obstacles
5. Marking strips highlight key switches/ID on panel cabinet
6. Photoluminous evacuation map
7. V-shape fire equipment signage

8. Fire extinguisher Backing
9. Anti-slip & warning aluminium stair nosing
10. Day Light Fluorescent anti-slip marking (R13)
11. Push Sign for door opening marking
12. Vinyl guidance line for door frame/highlight marking
13. Photoluminous Warning Marking (Blk/White)
14. Protection Corner



PERMALIGHT ■ Photo Reports for HV Room G07



- With normal lighting

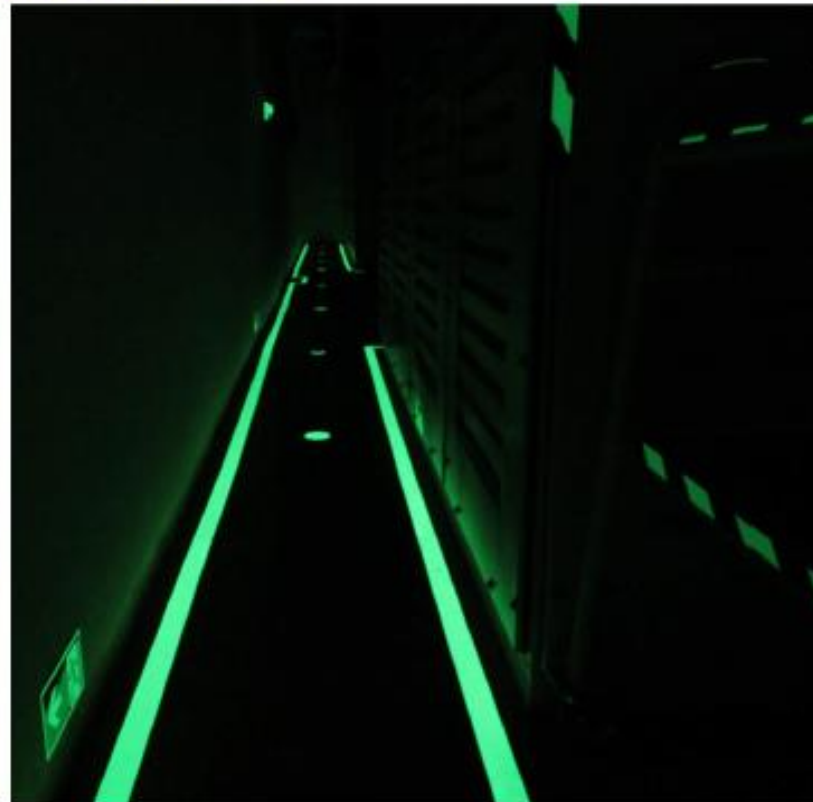

- Blackout Situation
-without normal lighting and EXIT light-box

1. Anti-slip marking strips for floor demarcation and showing exit path
2. Anti-slip floor dots for exit path marking
3. High level and low level directional signs
4. Bumper guards for visual warning and injury protection against obstacles
5. Marking strips highlight key switches/ID on panel cabinet
6. Photoluminous evacuation map
7. V-shape fire equipment signage

8. Fire extinguisher Backing
9. Anti-slip & warning aluminium stair nosing
10. Day Light Fluorescent anti-slip marking (R13)
11. Push Sign for door opening marking
12. Vinyl guidance line for door frame/highlight marking
13. Photoluminous Warning Marking (Blk/White)
14. Protection Corner



PERMALIGHT

Photo Reports for HV Room G07

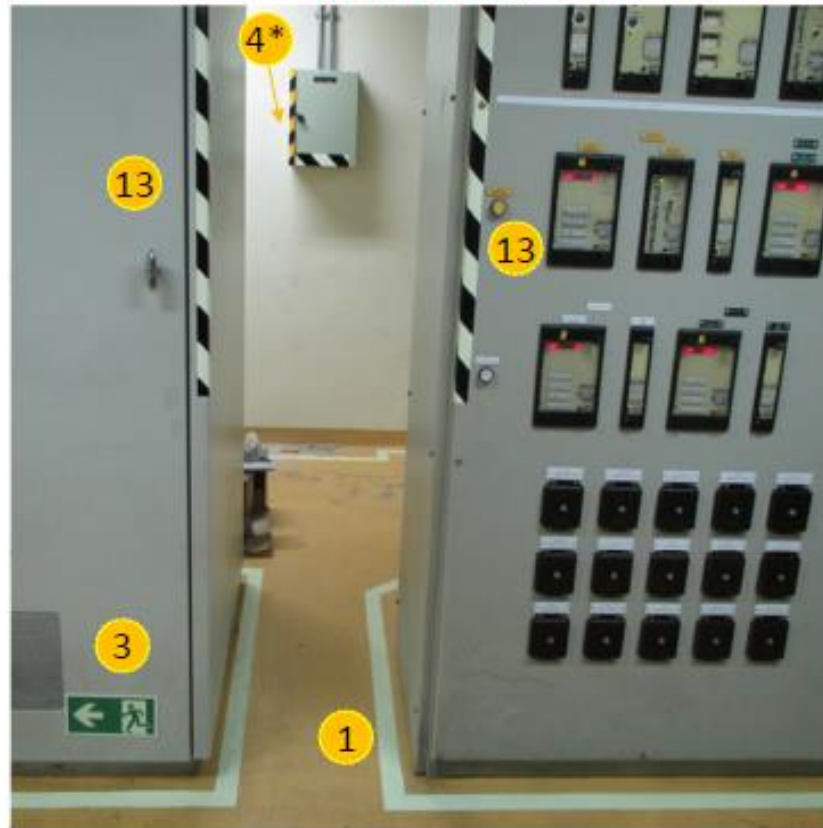

- With normal lighting

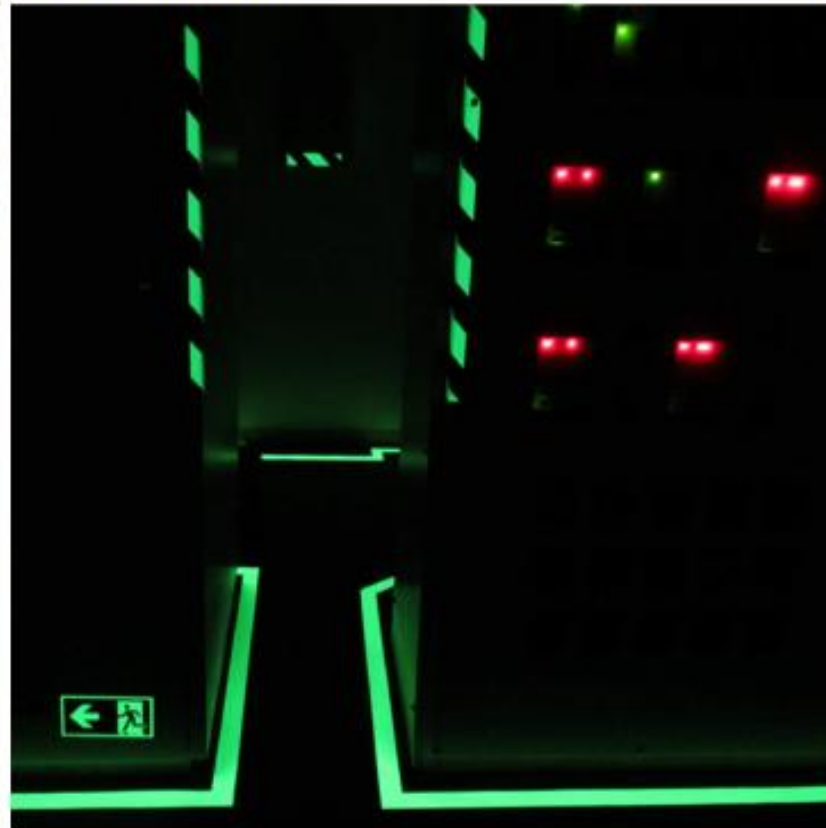

- Blackout Situation
-without normal lighting and EXIT light-box

1. Anti-slip marking strips for floor demarcation and showing exit path
2. Anti-slip floor dots for exit path marking
3. High level and low level directional signs
4. Bumper guards for visual warning and injury protection against obstacles
5. Marking strips highlight key switches/ID on panel cabinet
6. Photoluminous evacuation map
7. V-shape fire equipment signage

8. Fire extinguisher Backing
9. Anti-slip & warning aluminium stair nosing
10. Day Light Fluorescent anti-slip marking (R13)
11. Push Sign for door opening marking
12. Vinyl guidance line for door frame/highlight marking
13. Photoluminous Warning Marking (Blk/White)
14. Protection Corner



PERMALIGHT ■ Photo Reports for HV Room G07



• With normal lighting

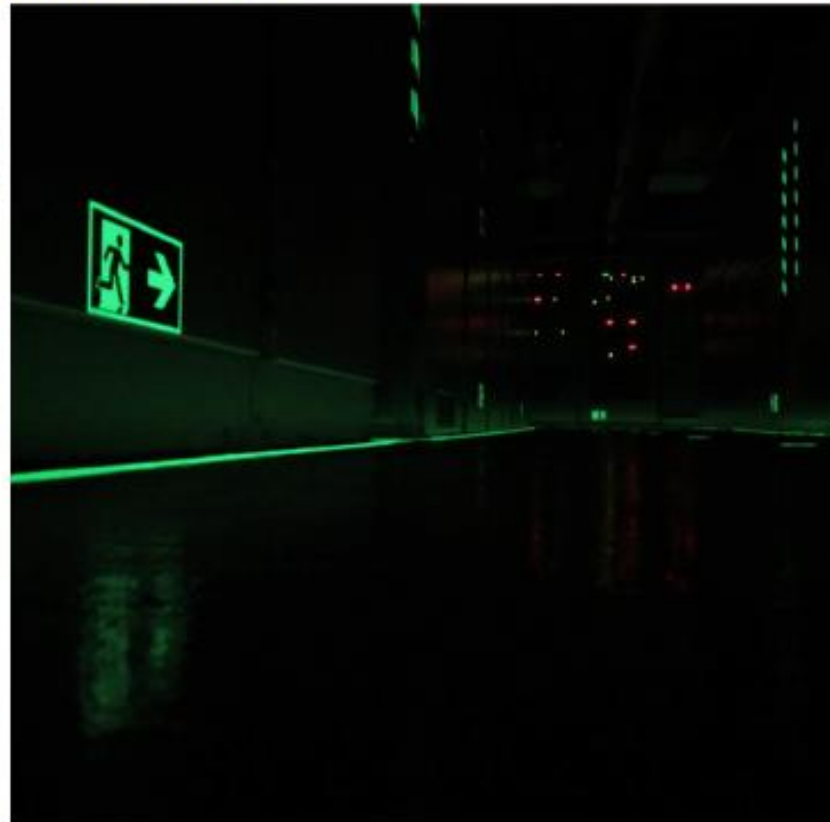

• Blackout Situation
-without normal lighting and EXIT light-box

Escape Route Signs



Fire Protection Signs



Safety Guidance System

Guidance Lines for Walls



Safety Guidance System Floor Markings



DIN 67510, ASR A3.4/3

Safety Guidance System

Door Markings



DIN 67510, ASR A3.4/3



Door frame

As an important exit, exits must be marked with yellow strips and color-coded.

- » self-adhesive
- » material: a



DIN 67510, ASR A3.4/3



Door hand

With this version, the position of the lighting cone is

- » suitable for
- » pointing right



Safety Guidance System Stair Markings



BGR 181



DIN 67 510, ASR A3.4/3

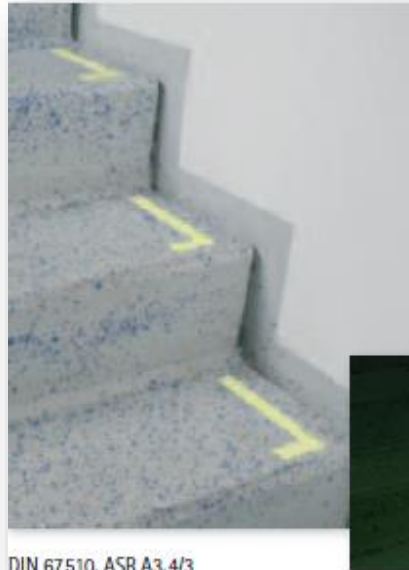

DIN 67 510, ASR A3.4/3



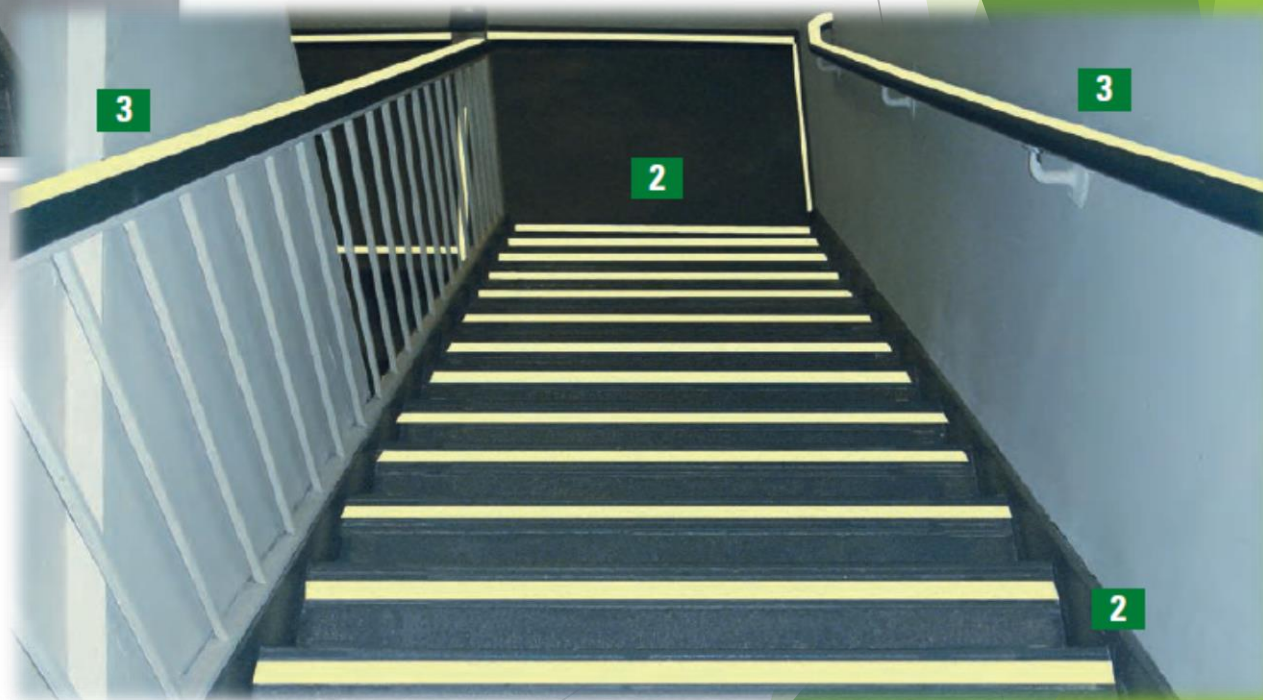
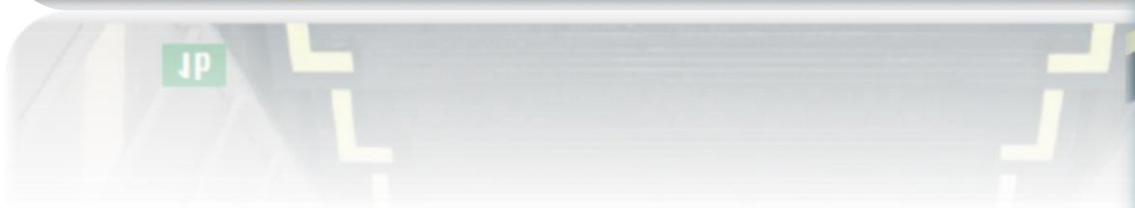
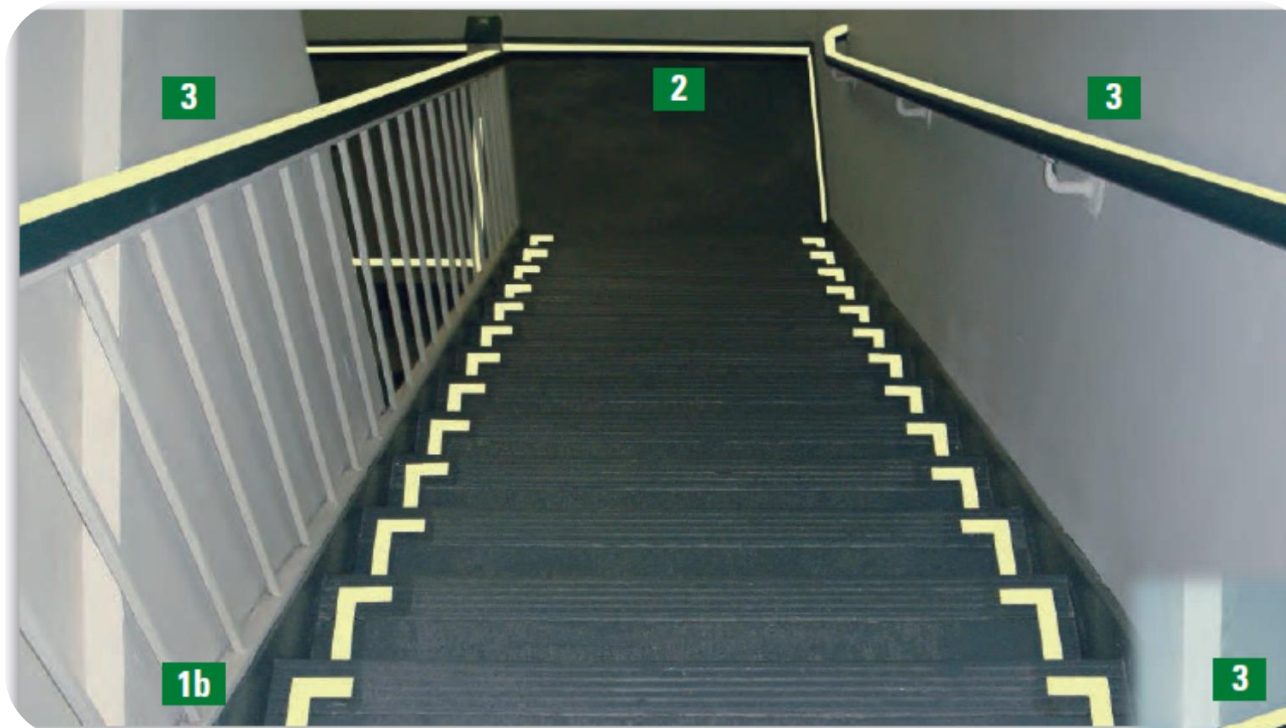

BUMPER

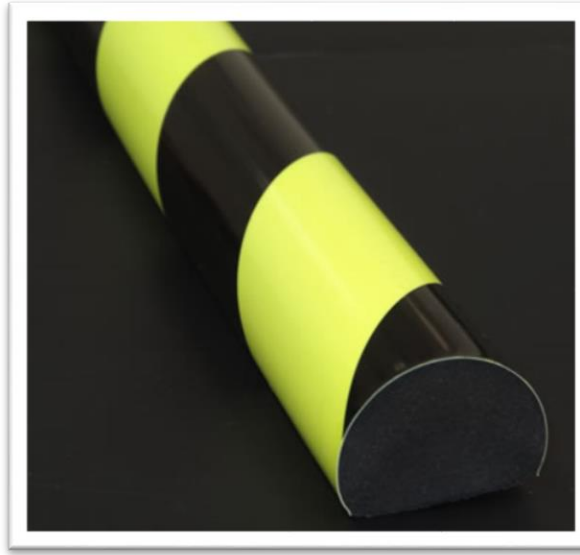

Luminance Quality	Lighting situation/Application area (best suitable for)	Luminance 10 min./60 min.	Decay time	Specifications DIN 67510
A Permalight® standard	Bright areas with permanent lighting or daylight, e.g. office rooms with windows.	23/3 mcd/m²	340 min. = approx. 6 h	23/3 mcd/m²
B Permalight® plus	Areas with constant lighting during operation time: in such office rooms dangerous spots can be recognized without difficulty.	55/8 mcd/m²	950 min. = approx. 16 h	50/7 mcd/m²
C Permalight® power 150	Areas with damped or only temporary lighting. Required for all buildings that are subject to ASR3.4/3: hospitals, nursing homes, airports, department stores, large hotels, power plants, event locations. Industry: factory halls, warehouses, production areas, hallways, machinery rooms etc. (according to ASR 7.3 min. 50 Lux constant lighting/4.000 K excitatory light during utilisation).	150/22 mcd/m²	2100 min. = approx. 35 h	140/20 mcd/m²
D Permalight® power 300	For areas with poor lighting and specific requirements on safety. Special solutions in accordance with ASR, ships, tunnels, abroad, etc. For internal demands of the client.	300/45 mcd/m²	3380 min. = approx. 56 h	260/35 mcd/m²
E Permalight® power 520	For special surroundings with very low lighting or only very short excitation intervals such as tunnels, under- ground crossing, subways, etc. For special solutions in cooperation with the client.	520/70 mcd/m²	5700 min. = approx. 95 h	520/70 mcd/m²
S Permalight® spezial	Individual solutions for all special cases.	– depending on requirement – Ask our specialists!		

APPLICATION AREAS : METRO

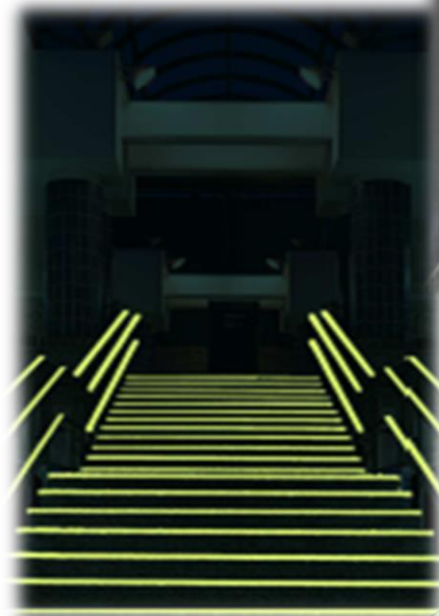

APPLICATION AREAS :

OFFICE BUILDING

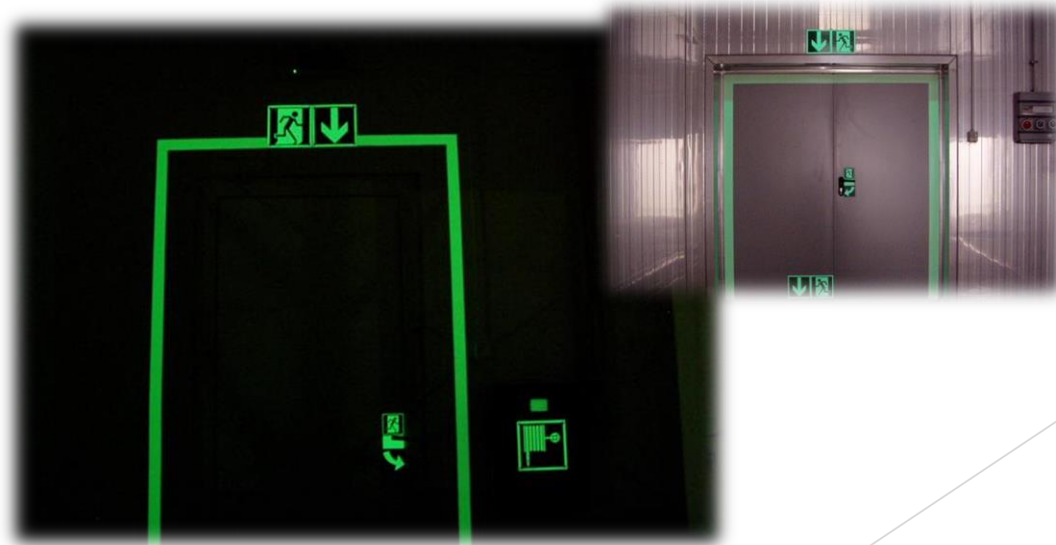
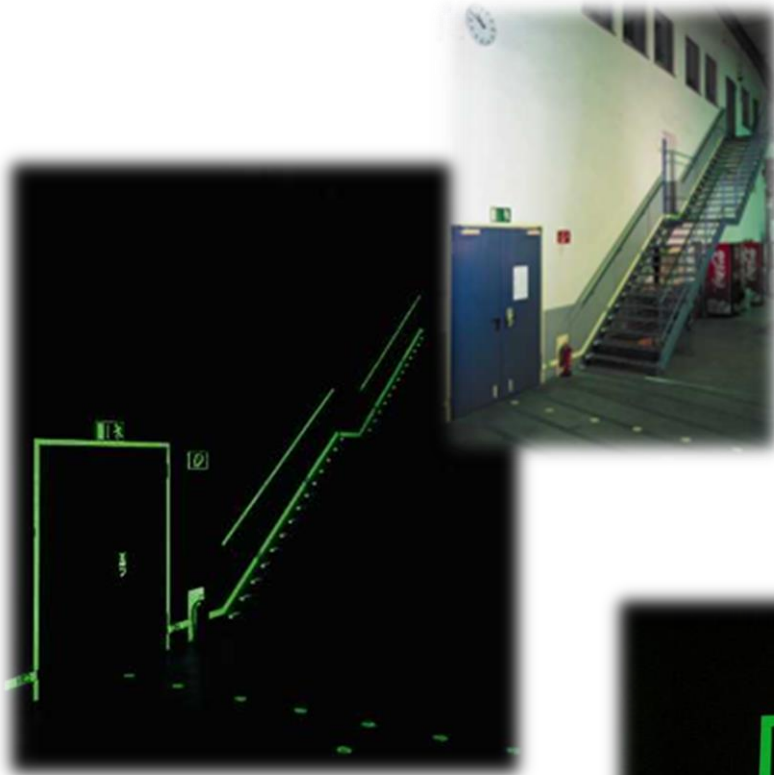



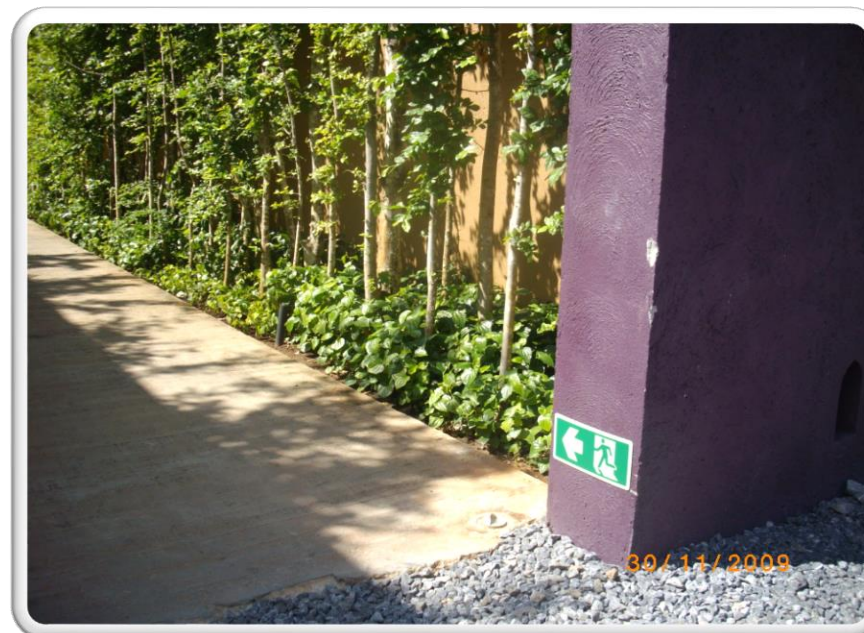
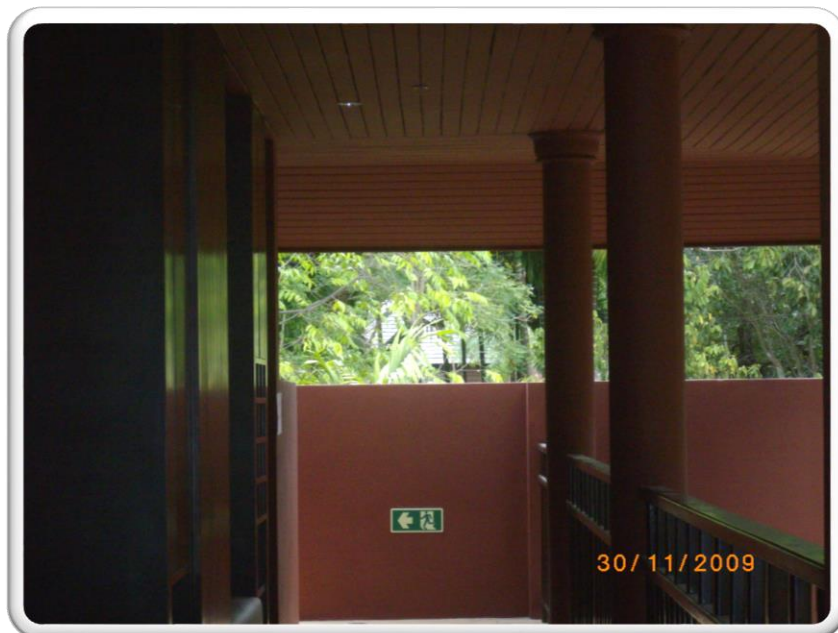



REFERENCES โรงแยกก๊าซธรรมชาติ จ.ระยอง



SALE GAS

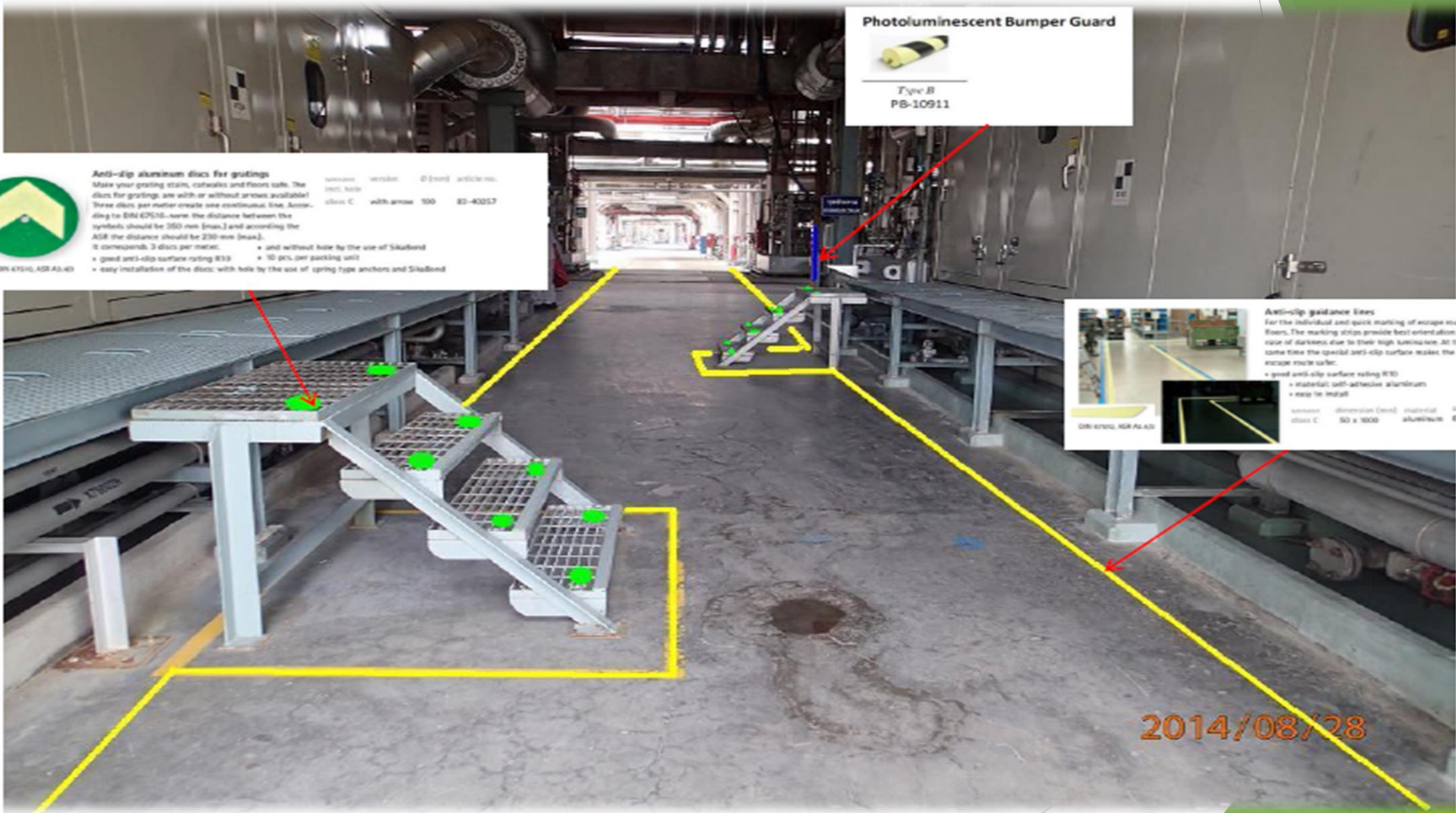

Photoluminescent Bumper Guard



Type B
PB-10911



Anti-slip aluminum discs for gratings
Make your grating stairs, catwalks and floors safe. The discs for gratings are with or without arrows available! Three discs per meter create one continuous line. According to EN 428-2, the distance between the symbols should be 350 mm (max.) and according to the ASR the distance should be 230 mm (max.). It corresponds 3 discs per meter.

summa	version	Ø (mm)	article no.
class C	with arrow	100	83-40257

- good anti-slip surface rating R10
- easy installation of the discs: with hole by the use of spring type anchors and Sikabond
- anti without hole by the use of Sikabond
- 10 pcs. per packing unit

DN 428-2, ASR A3-A5



Anti-slip guidance lines
For the individual and quick marking of escape routes on floors. The marking strips provide best orientation in case of darkness due to their high luminance. At the same time the special anti-slip surface makes the escape route safer.

- good anti-slip surface rating R10
- material: self-adhesive aluminum
- easy to install

summa	dimension (mm)	material	article no.
class C	50 x 1000	aluminum	83-40000

DN 428-2, ASR A3-A5

2014/08/28

SALE GAS

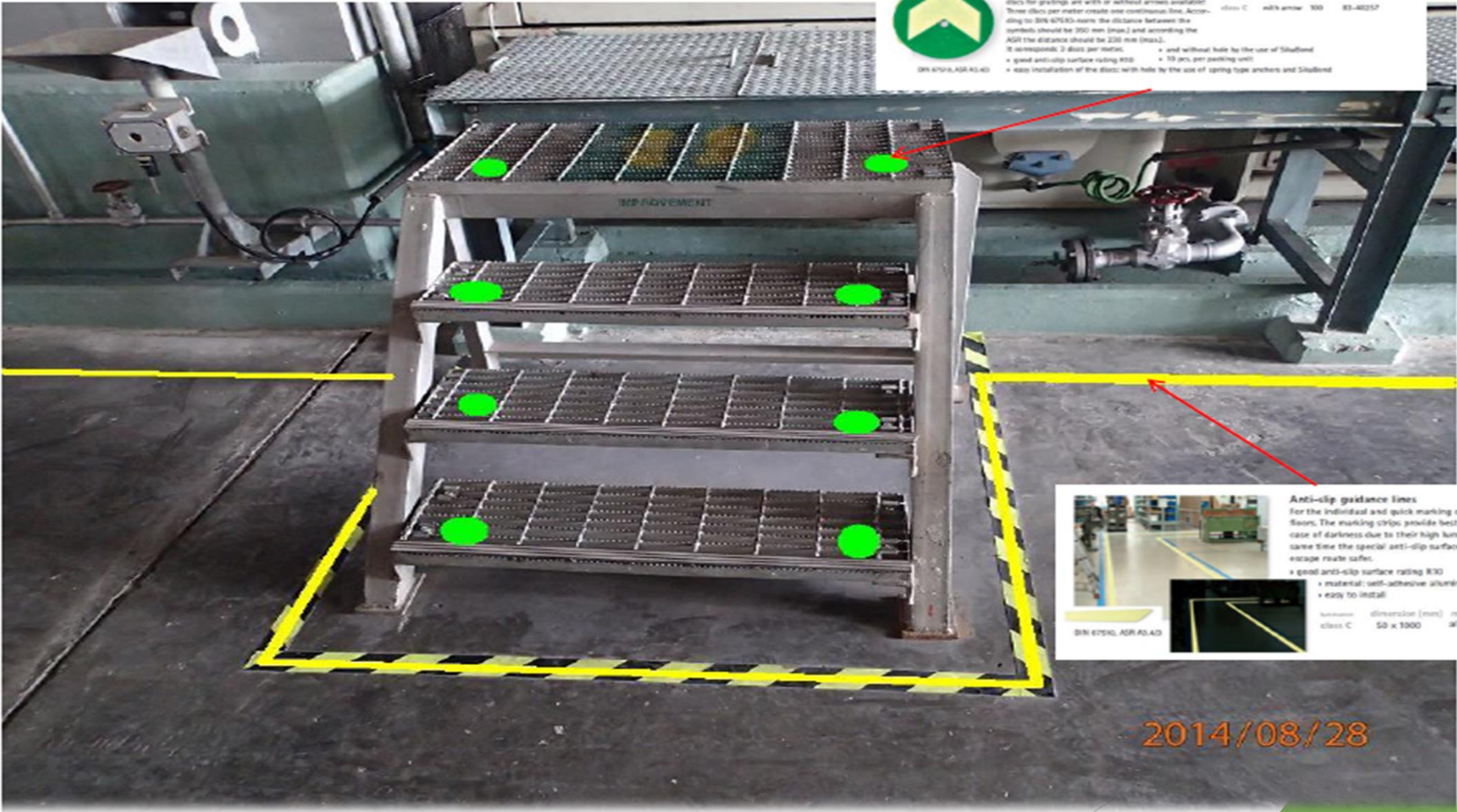

DN 6750, ASR A340

Anti-slip aluminum discs for gratings

Make your grating stairs, walkways and floors safe. The discs for gratings are with or without arrows available. Three discs per meter create one continuous line. According to DIN 6750 norms the distance between the symbols should be 350 mm (max.) and according to ASR the distance should be 230 mm (max.). It corresponds to 3 discs per meter.

- good anti-slip surface rating R10
- and without hole by the use of Stalldent
- 10 pcs. per parking unit
- easy installation of the discs with hole by the use of spring type anchors and Stalldent

norm	version	Ø [mm]	article no.
DN 6750	with arrow	300	83-40257



DN 6750, ASR A340

Anti-slip guidance lines

For the individual and quick marking of escape routes on floors. The marking strips provide best orientation in case of darkness due to their high luminance. At the same time the special anti-slip surface makes the escape route safer.

- good anti-slip surface rating R10
- material: self-adhesive aluminium
- easy to install

norm	dimension [mm]	material	article no.
class C	50 x 1000	aluminium	83-40059

2014/08/28

SALE GAS

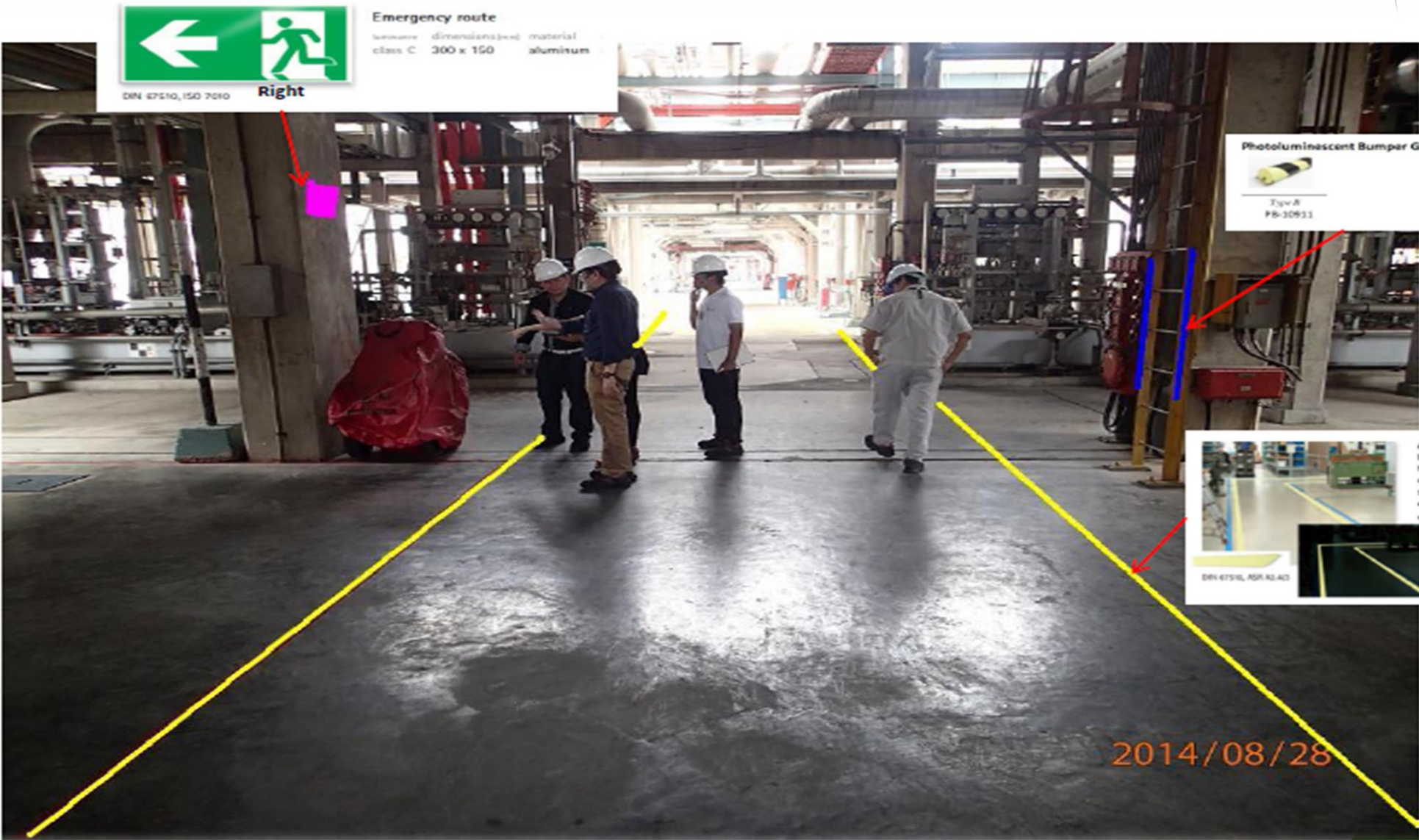

DIN 47510, ISO 7010

Right

Emergency route

Normative	dimensions (mm)	material
class C	300 x 150	aluminum

Photoluminescent Bumper Guard



Type A
PB-30933



Anti-slip guidance lines
For the individual and quick marking of escape routes a floor. The marking strips provide best orientation in case of darkness due to their high luminance. At the same time the special anti-slip surface makes the escape route safer.

- good anti-slip surface rating R10
- material: self-adhesive aluminum
- easy to install

DIN 47510, ASR A2-A3

Normative	dimension (mm)	material	width
class C	50 x 1000	aluminum	83-83

GAS WELL



DIN 67510, ISO 7010

Right

Emergency route

luminaire	dimensions (mm)	material
class C	300 x 150	aluminum



DIN 67516, ASR A3.4D

Anti-slip aluminum discs for gratings

Make your grating stairs, catwalks and floors safe. The discs for gratings are with or without arrows available! Three discs per meter create one continuous line. According to DIN 67510-norm the distance between the symbols should be 350 mm (max.) and according the ASR the distance should be 230 mm (max.). It corresponds 3 discs per meter.

- good anti-slip surface rating R10
- easy installation of the discs: with hole by the use of spring type anchors and SikaBond
- and without hole by the use of SikaBond
- 10 pcs. per packing unit

luminaire	version	© (mm)	article no.
incl. hole			
class C	with arrow	100	83-40257

GAS WELL



Right



DIN 67510, ISO 7010

Emergency route

luminaire	dimensions (mm)	material
class C	300 x 150	aluminum

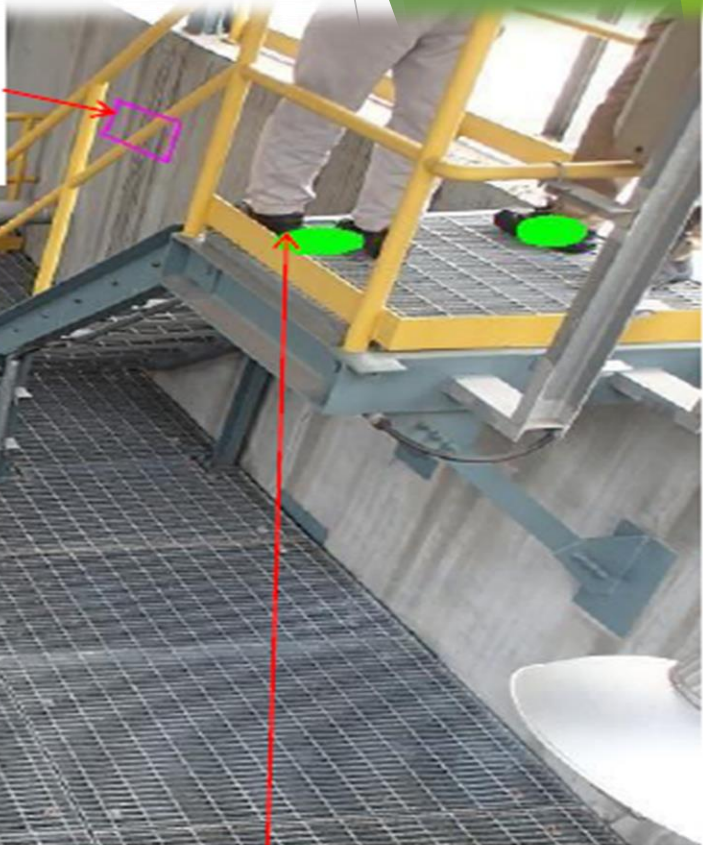

Photoluminescent warning marking (black/white)

Striking marking of stationary and permanent obstacles. Flexible marking with this material. Due to the photoluminescent effect dangerous places can clearly be recognized - even in the darkness!
* material: self-adhesive tape on roll



luminaire	dimensions (mm)	material	article no.
pointing right	50 x 16000	foil	82-44052
class C			



DIN 67510, ASR A3.4/2

Anti-slip aluminum discs for gratings

Make your grating stairs, catwalks and floors safe. The discs for gratings are with or without arrows available! Three discs per meter create one continuous line. According to DIN 67510-norm the distance between the symbols should be 350 mm (max.) and according the ASR the distance should be 230 mm (max.). It corresponds 3 discs per meter.

- * and without hole by the use of SikaBond
- * 10 pcs. per parking unit
- * easy installation of the discs: with hole by the use of spring type anchors and SikaBond

luminaire	version	Ø (mm)	article no.
incl. hole	with arrow	100	83-40257
class C			

GAS WELL

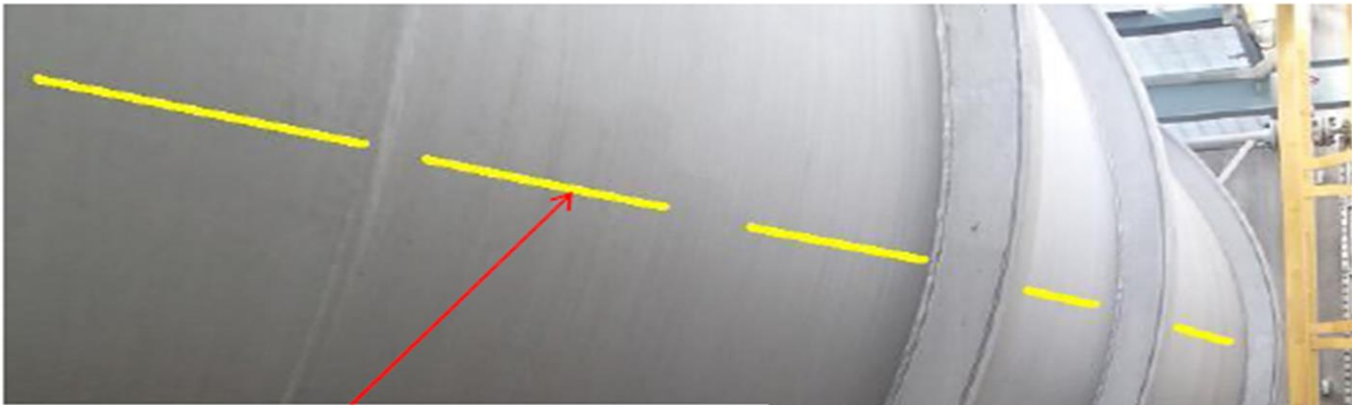

Anti-slip dots
Photoluminescent anti-slip dots with high luminance, well suited for the installation of a safety guidance system. Place at least 3 dots per meter. Available in two versions and sizes: with or without arrow, in Ø 60 mm and Ø 100 mm. We recommend our 3M Edge sealing compound and 3M Scotch Weld primer for a perfect adhesion.

- » good anti-slip surface rating R10
- » material: self-adhesive polycarbonate
- » 10 pcs. per packing unit

21N 47610, MSR A24/3

luminance	version	Ø [mm]	article no.
class C	with arrow	100	83-4011



Guidance line on rolls
Photoluminescent guidance lines for the striking marking of dangerous places and obstacles such as doors, machinery and much more.

- » tape 25 m in 3 different widths
- » self-adhesive tape with excellent adhesion
- » easy installation on all clean surfaces

luminance	dimension (mm)	material	article no.
class C	25 x 25000	PVC-tape	82-40708



Photoluminescent warning marking (black/white)
Striking marking of stationary and permanent obstacles. Flexible marking with this material. Due to the photoluminescent effect dangerous places can clearly be recognized – even in the darkness!

- » material: self-adhesive tape on roll

luminance	dimensions (mm)	material	article no.
pointing right class C	50 x 16000	foil	82-44052

2014/08/28

GAS WELL



Anti-slip dots
Photoluminescent anti-slip dots with high luminance are well suited for the installation of a safety guidance system. Place at least 3 dots per meter. Available in two versions and sizes: with or without arrow, in Ø 60 mm and Ø 100 mm. We recommend our 3M Edge sealing compound and 3M Scotch Field primer for a perfect adhesion.

- » good anti-slip surface rating R10
- » material: self-adhesive polycarbonate
- » 10 pcs. per packing unit

luminance	version	Ø (mm)	article no.
class C	with arrow	100	83-40119



Photoluminescent warning marking (black/white)
Striking marking of stationary and permanent obstacles. Flexible marking with this material. Due to the photoluminescent effect dangerous places can clearly be



recognized - even in the darkness!
» material: self-adhesive tape on roll

luminance	dimensions (mm)	material	article no.
pointing right class C	50 x 16000	foil	82-44052



Guidance line on rolls
Photoluminescent guidance lines for the striking marking of dangerous places and obstacles such as doors, machinery and much more.

- » tape 25 m in 3 different widths
- » self-adhesive tape with excellent adhesion
- » easy installation on all clean surfaces

luminance	dimension (mm)	material	article no.
class C	25 x 16000	foil	83-40119



2014/08/28

SALE GAS

Before



After



SALE GAS

Before



After



SALE GAS

Before



After

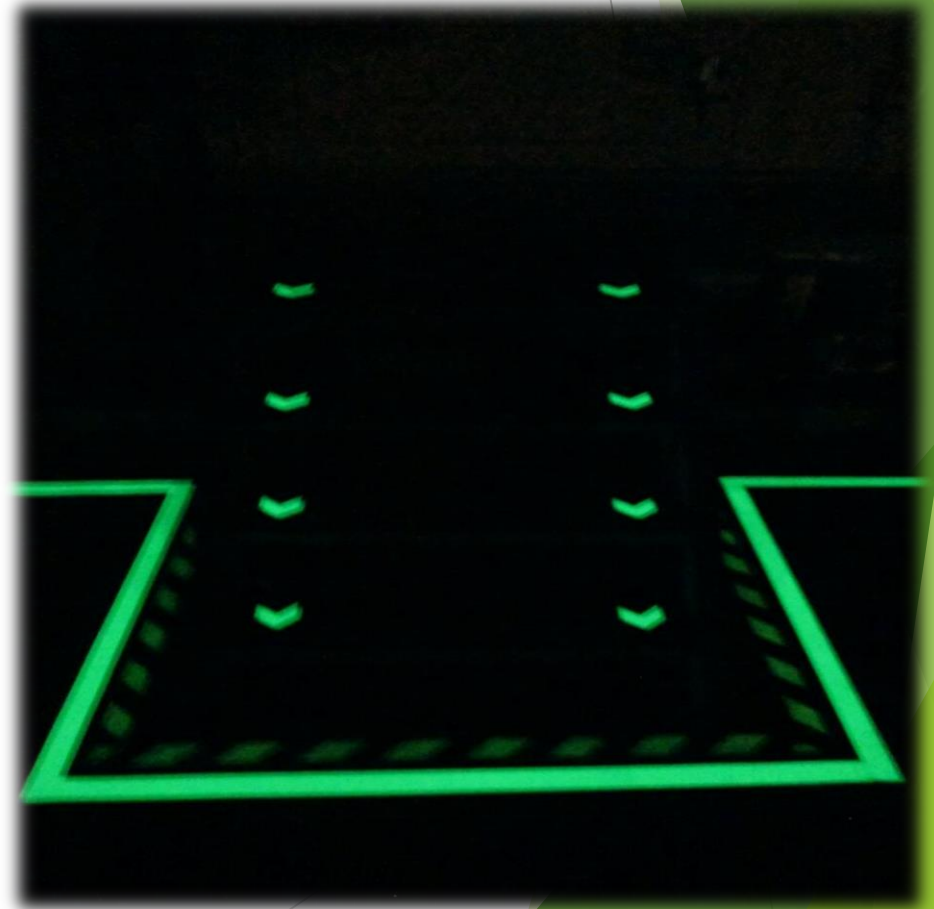

SALE GAS

Before



After

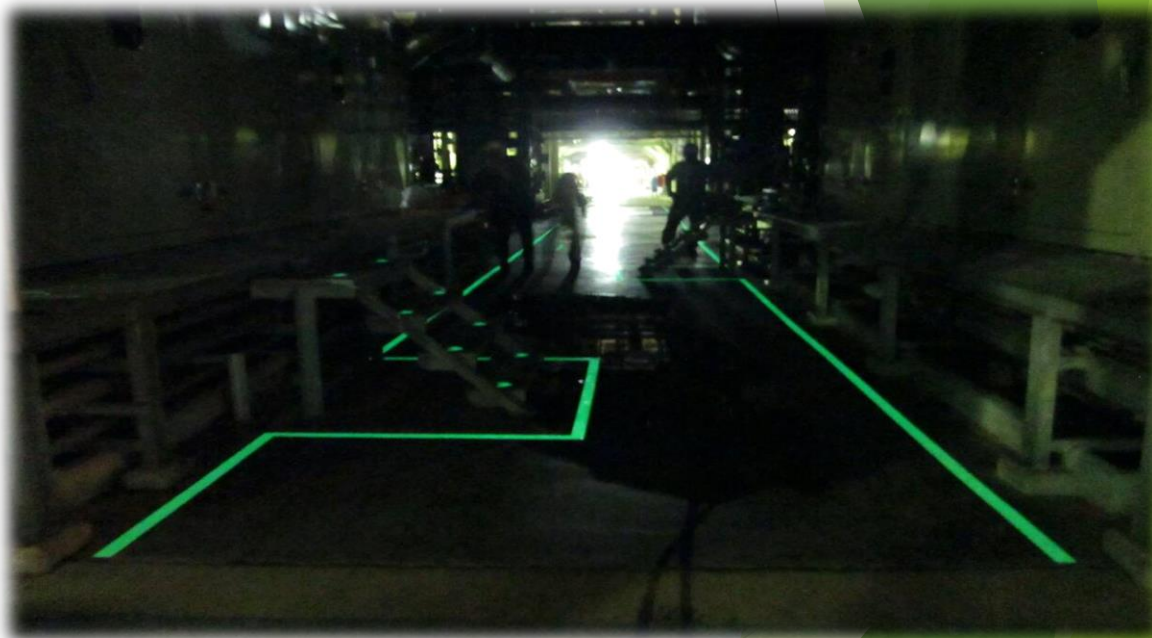

SALE GAS

Before



After

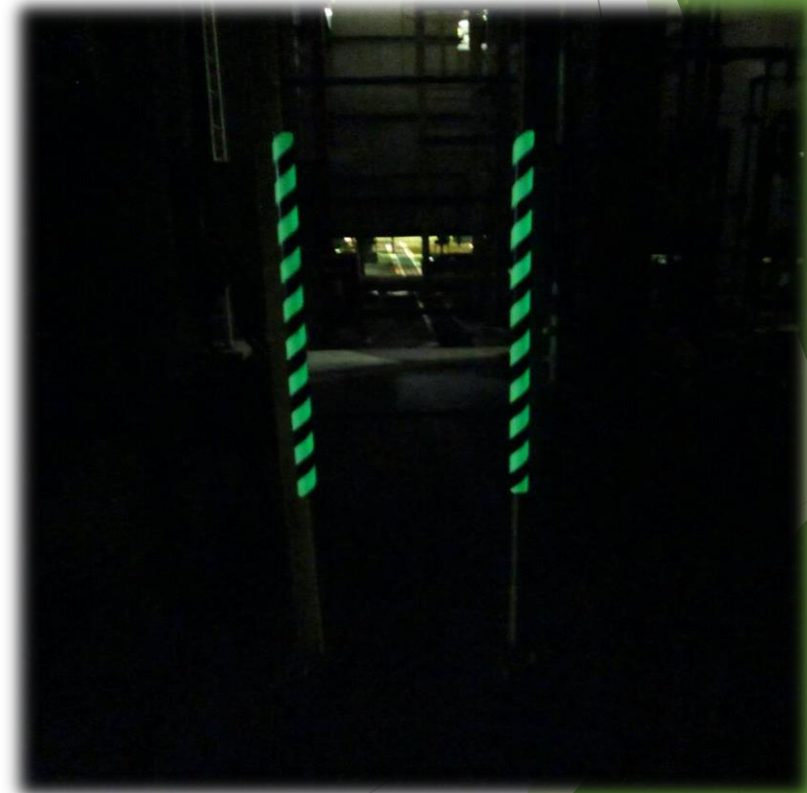

SALE GAS

Before



After



SALE GAS

Before



After



GAS WELL

Before



After



GAS WELL

Before



After



ป้ายเรื่องแสง และแถบเรื่องแสง

CPF โรงงานอาหารสำเร็จรูป หนองจอก



WAREHOUSE CPF

โรงงานอาหารสำเร็จรูป หนองจอก



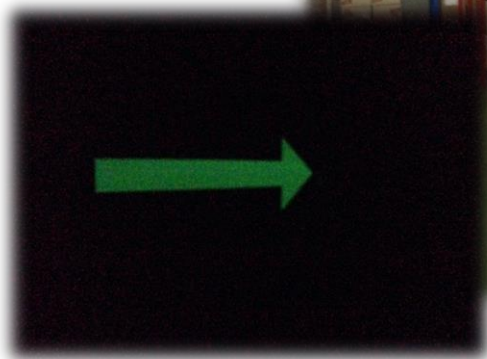

ตัวอย่าง ป้ายเรืองแสง และแถบบันได

เส้นทางอพยพ



Before



After

Before



After

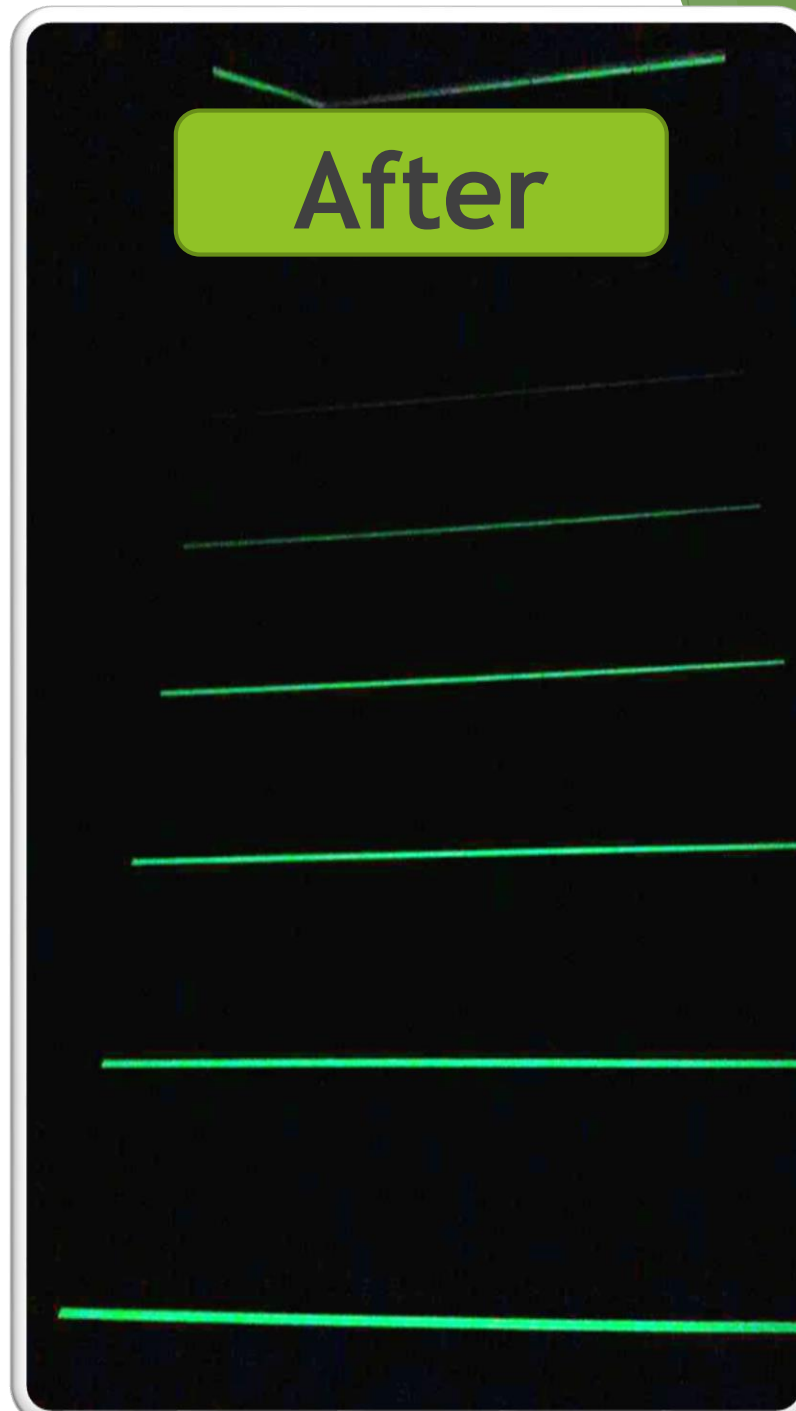



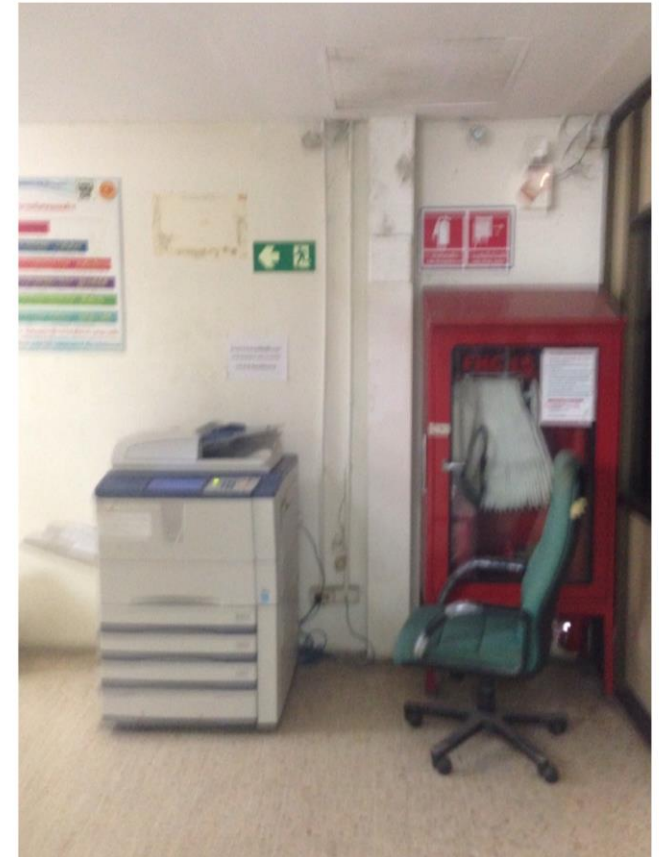

REFERENCE CP RETAILINK

ส่วน โรงคั่วกาแฟ



ซีพี รีเทลลิงค์ จำกัด



โรงคั่วกาแฟ CP RETAILINK



Emergency Route Left
ป้ายทางออก ไปทางซ้าย

cp retailink

โรงคั่วกาแฟ CP RETAILINK

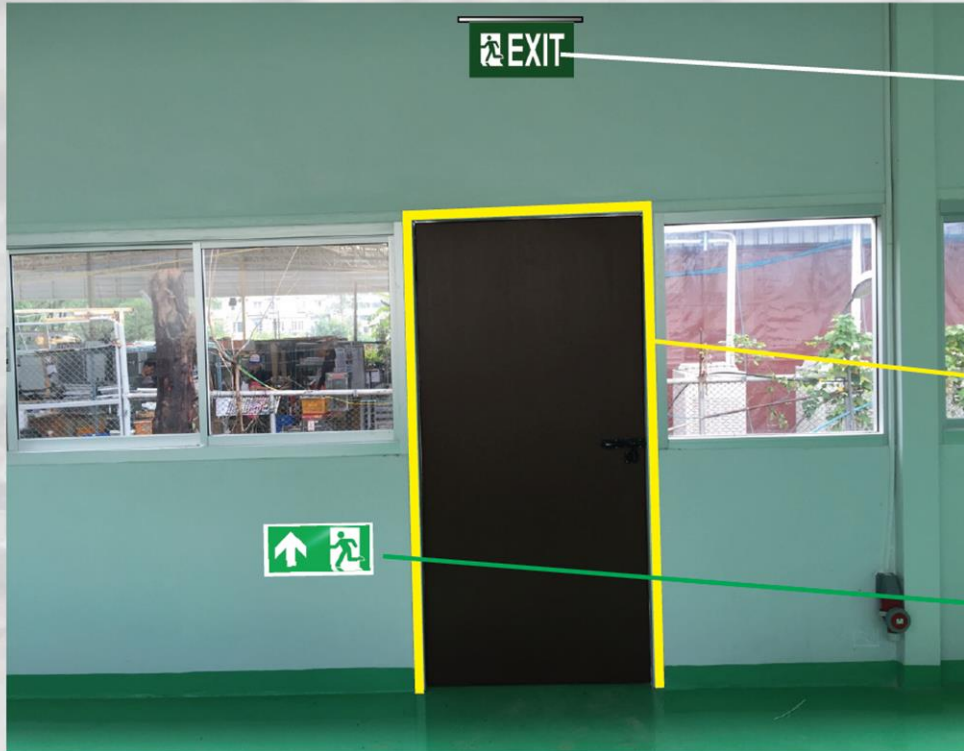

cp retailink

โรงคั่วกาแฟ CP RETAILINK

Permanent
ENGINEERING SOLUTION



Emergency Route Right

ป้ายทางออก ไปทางขวา

cp retailink

โรงคั่วกาแฟ CP RETAILINK

Permanent
ENGINEERING SOLUTION

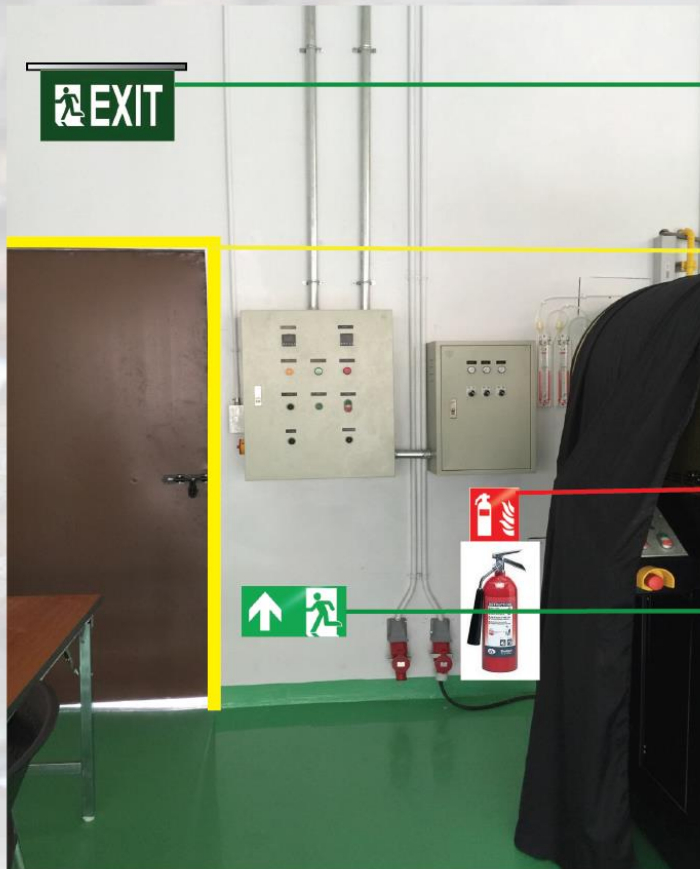

Exit sign

ป้ายไฟ ทางออก



PVC Tape class C

แถบเรืองแสงแบบม้วน



Fire Extinguisher

ป้ายเรืองแสง ถังดับเพลิง



Emergency Route Top Right

ป้ายทางออก ไปทางตรง

cp retailink

โรงคั่วกาแฟ CP RETAILINK

Permanent
ENGINEERING SOLUTION



Emergency Route Top Right

ป้ายทางออก ไปทางตรง

cp retailink

โรงคั่วกาแฟ CP RETAILINK

Permanent
ENGINEERING SOLUTION



Emergency Route Top Right

ป้ายทางออก ไปทางตรง

cp retailink

โรงคั่วกาแฟ CP RETAILINK

Permanent
ENGINEERING SOLUTION



Fire Extinguisher

ป้ายเรืองแสง ถังดับเพลิง

cp retailink



Before



After



Before



After



Before



After



Before



After

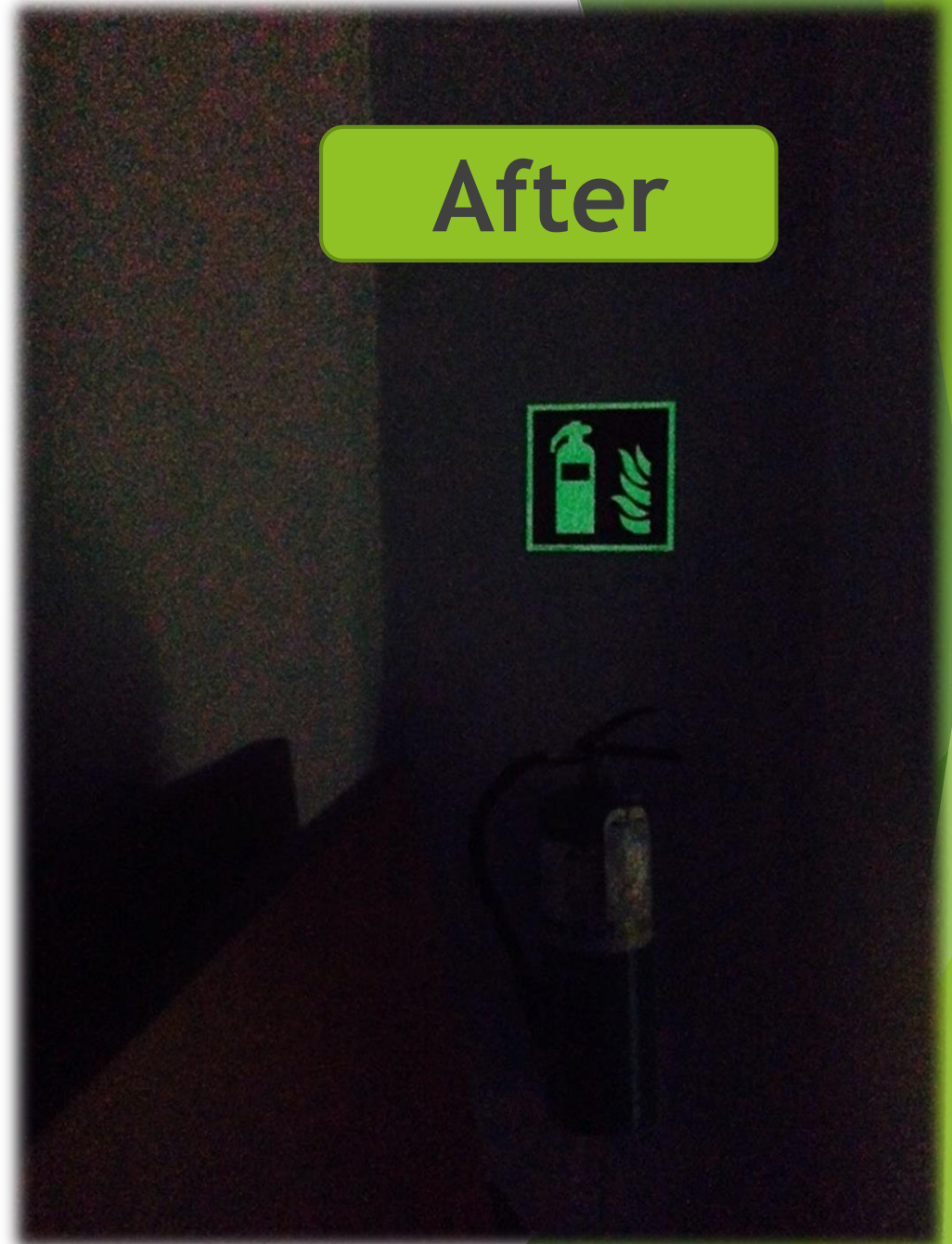

Before



After



จุดอื่น ๆ ในโรงคั่วกาแฟ

